



# VOLVO 740

1989

Wiring Diagrams

## CI-fuel injection, B200/230 E

- 2 Ignition switch
  - 4 Ignition coil
  - 5 Distributor
  - 9 Starter motor
  - 11 Fuse box
  - 29 Positive terminal
  - 31 Central electrical unit ground panel
  - 80 Thermal time switch
  - 119 Electronic pump relay
  - 188 Start injector
  - 189 Control pressure regulator
  - 190 Auxiliary air valve
  - 210 Tank pump
  - 211 Fuel pump
  - 212 Service socket
  - 260 Ignition system control unit
  - 293 Idle increase relay
  - 419 Ignition system power stage
- B Ground point, right A-post
  - C Connector, left wheel housing
  - D Connector, left A-post
  - E Connector in boot
  - F Ground point in boot
  - G Connector at electrical distribution unit
  - H Ground point on engine
  - J Connector at electrical distribution unit
  - K Connector, left A-post

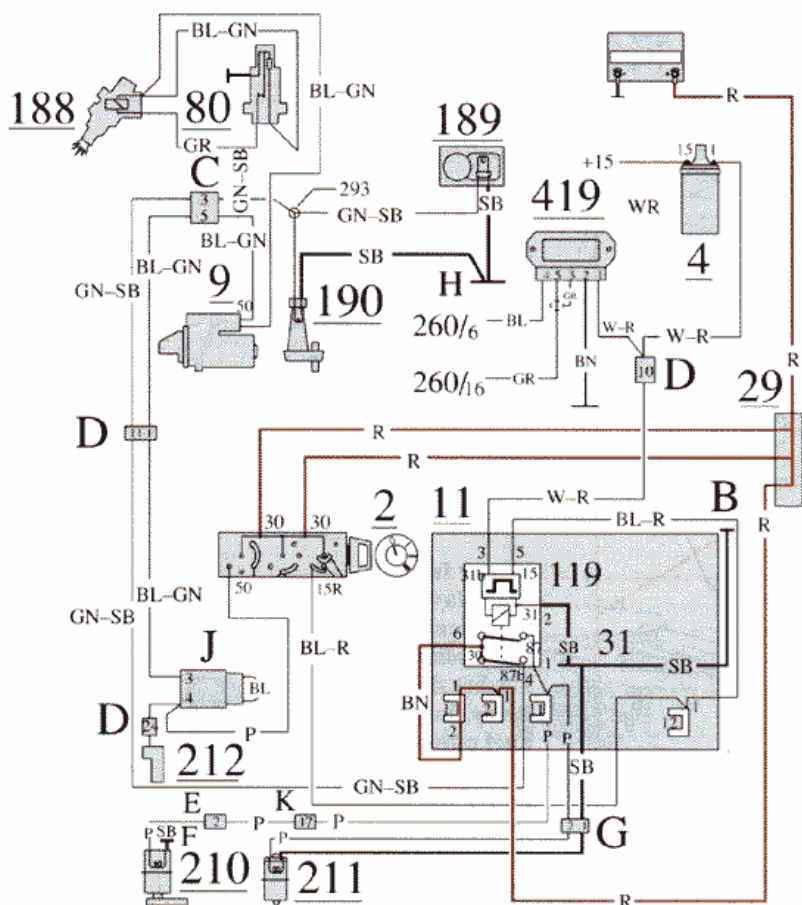

Starting, cold engine

Starting, hot engine

Stalled  
(Ignition on, engine not running)

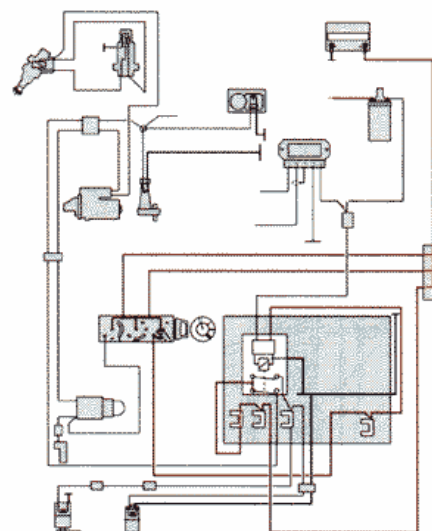

Engine running

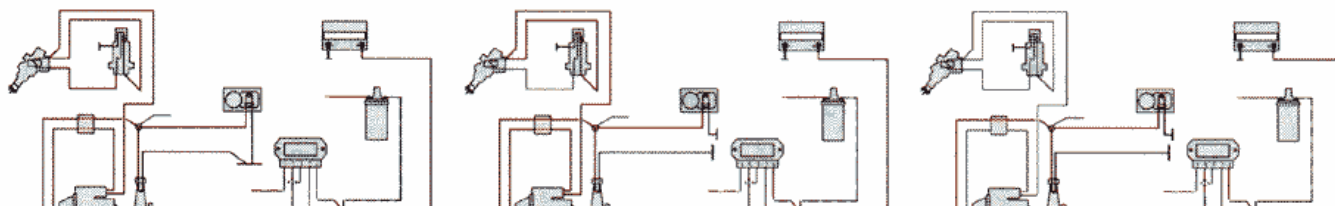

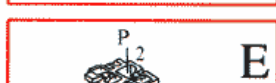
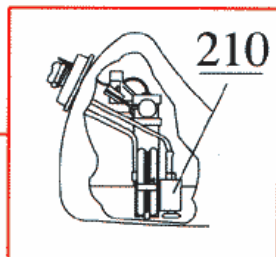
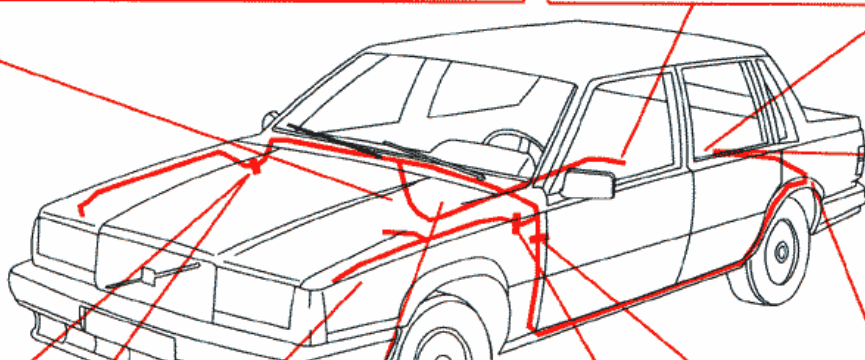
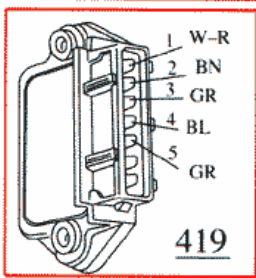
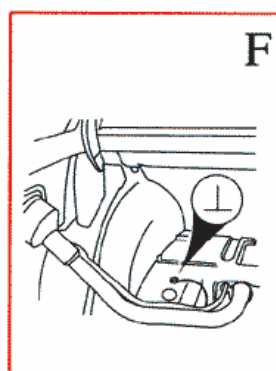
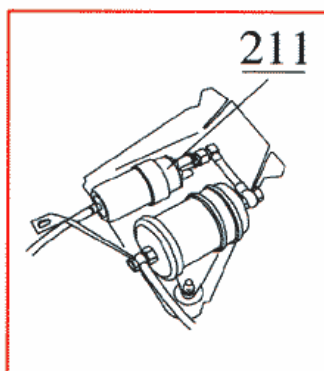
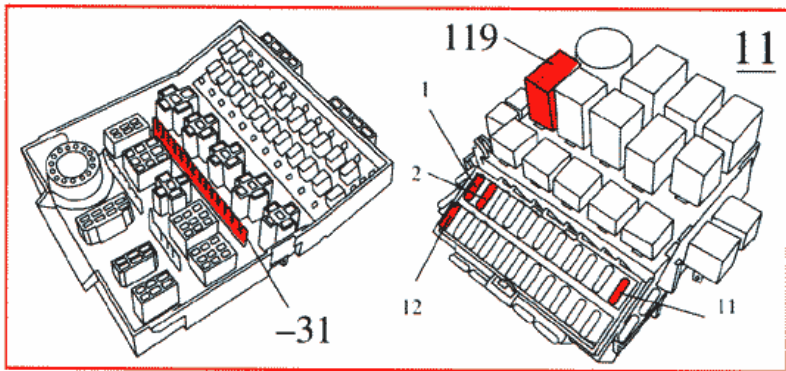
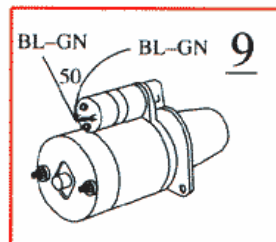
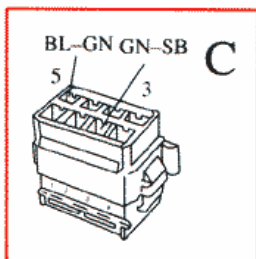
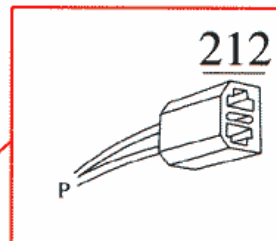
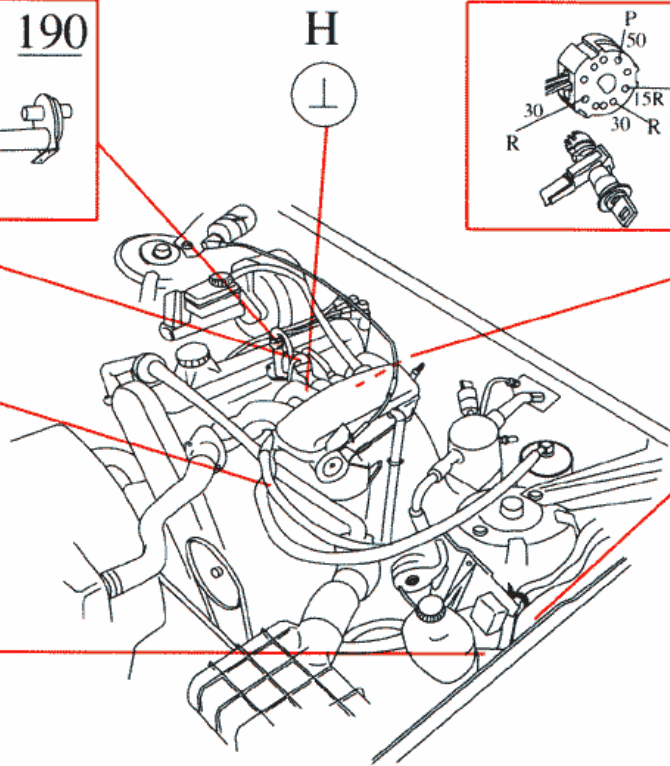
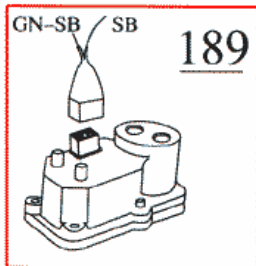
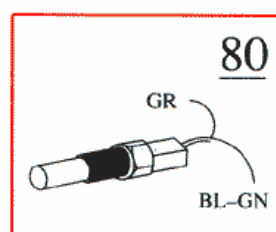
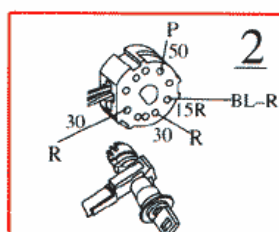
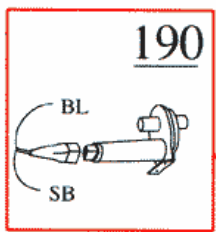
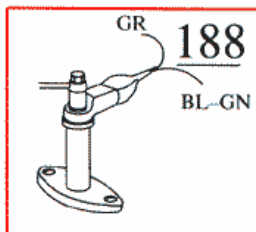
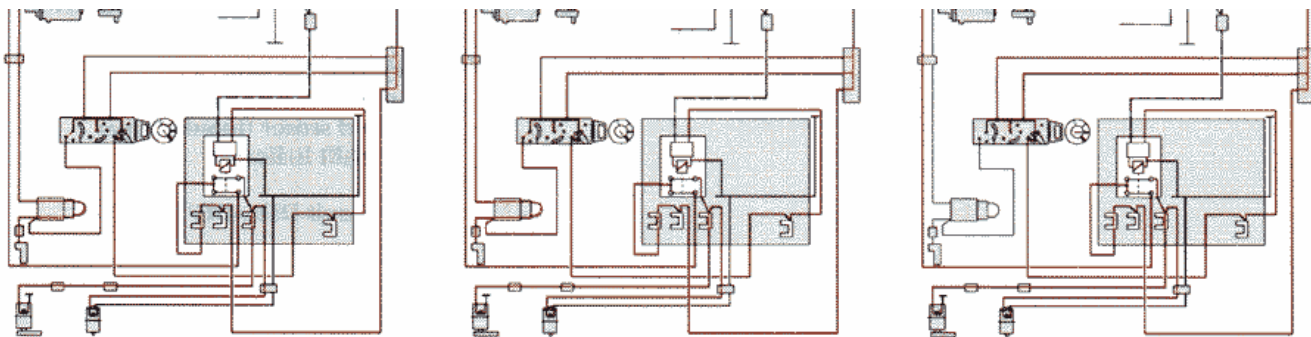



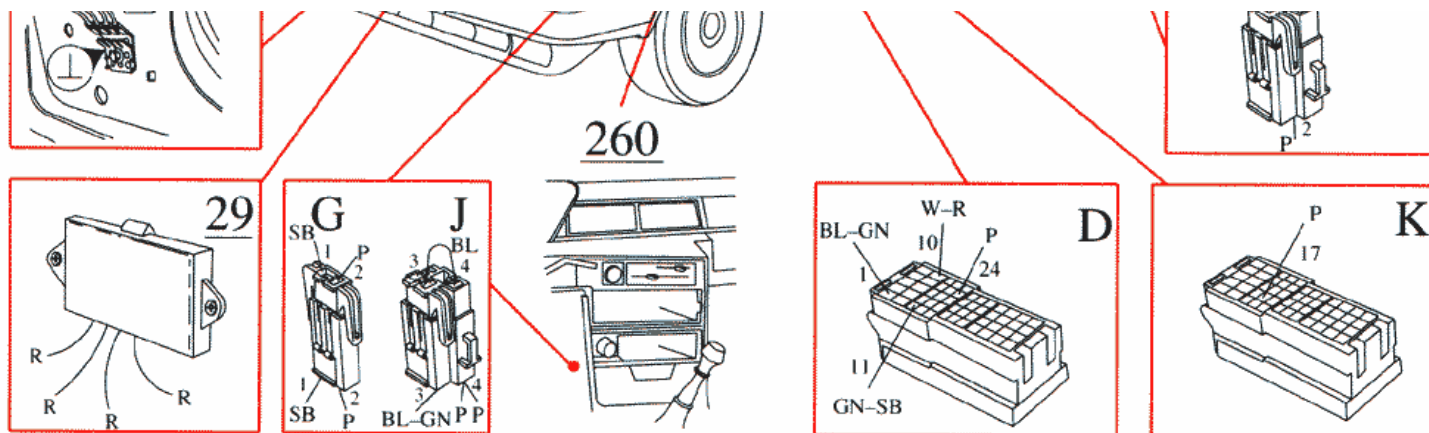

### Motronic, B200/230ET

- |   |  |   |
|---|--|---|
| 1 Battery                                       | 185 Charge air temperature sensor            | A Connector, right wheel housing          |
| 2 Ignition switch                               | 186 Air flow meter                           | B Connector, bulkhead                     |
| 4 Ignition coil                                 | 188 Start injector                           | C Connector, bulkhead                     |
| 9 Starter motor                                 | 210 Tank pump                                | D Connector, right wheel housing          |
| 11 Fuse box                                     | 211 Fuel pump 6.5 A                          | E Connector, right A-post                 |
| 29 Positive terminal                            | 212 Service socket for running starter motor | F Connector, left A-post                  |
| 31 Ground panel in electrical distribution unit | 213 Throttle switch Motronic                 | G Ground point, left wing                 |
| 71 Start inhibitor switch                       | 214 Crankshaft position sensor               | H Ground point on inlet manifold          |
| 80 Thermal time switch                          | 215 Engine speed sensor                      | J Connector, left A-post                  |
| 84 Coolant temperature sensor                   | 216 Control unit Motronic                    | K Connector, electrical distribution unit |
| 135 Relay, Motronic                             | 289 Power stage, Motronic                    | L Connector, left wheel housing           |
| 176 CIS control unit                            | 361-364 Injectors                            | P Ground point, right A-post              |
|   | 376 Ballast resistor                         | Q Ground point in boot                    |
|   | 464 Radio interference suppression           | Y Connector, electrical distribution unit |

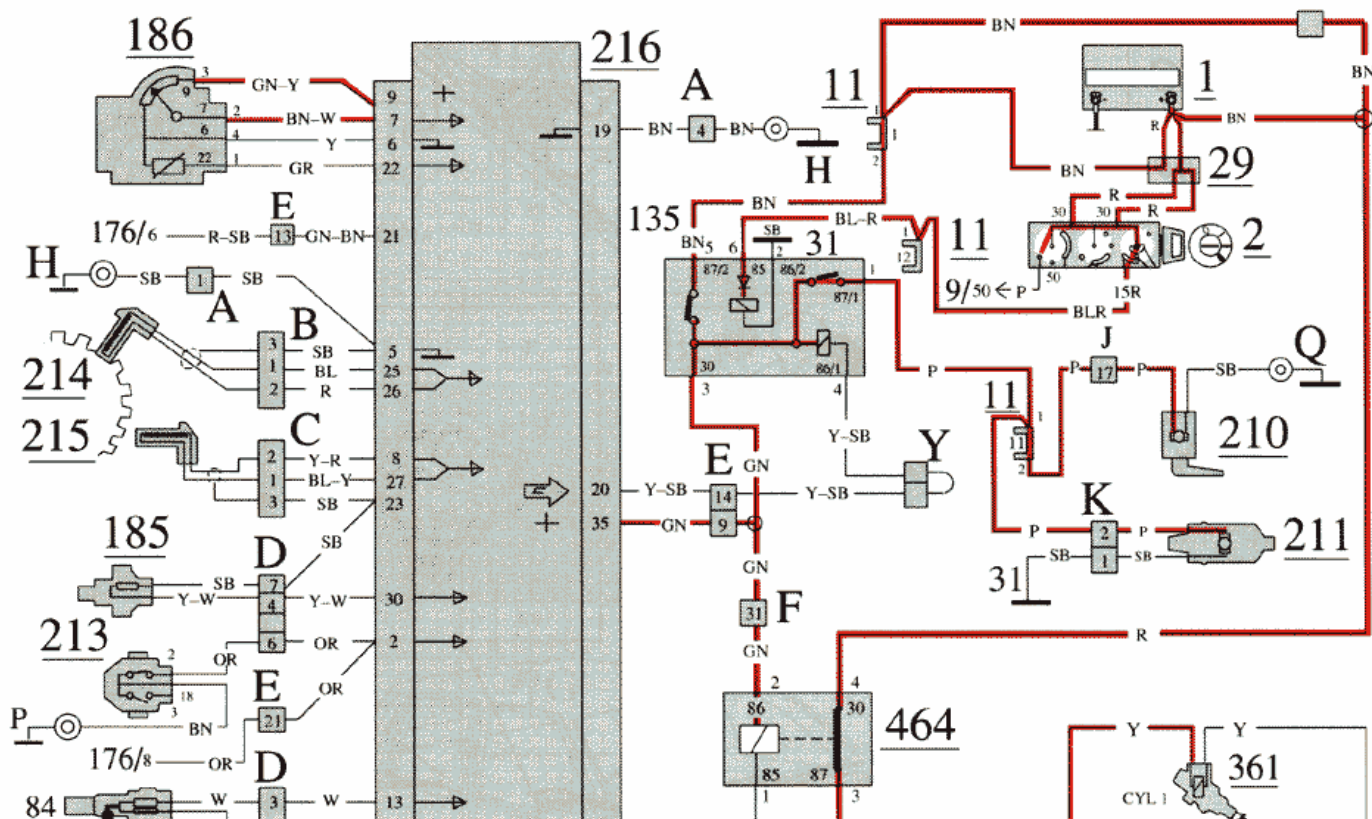

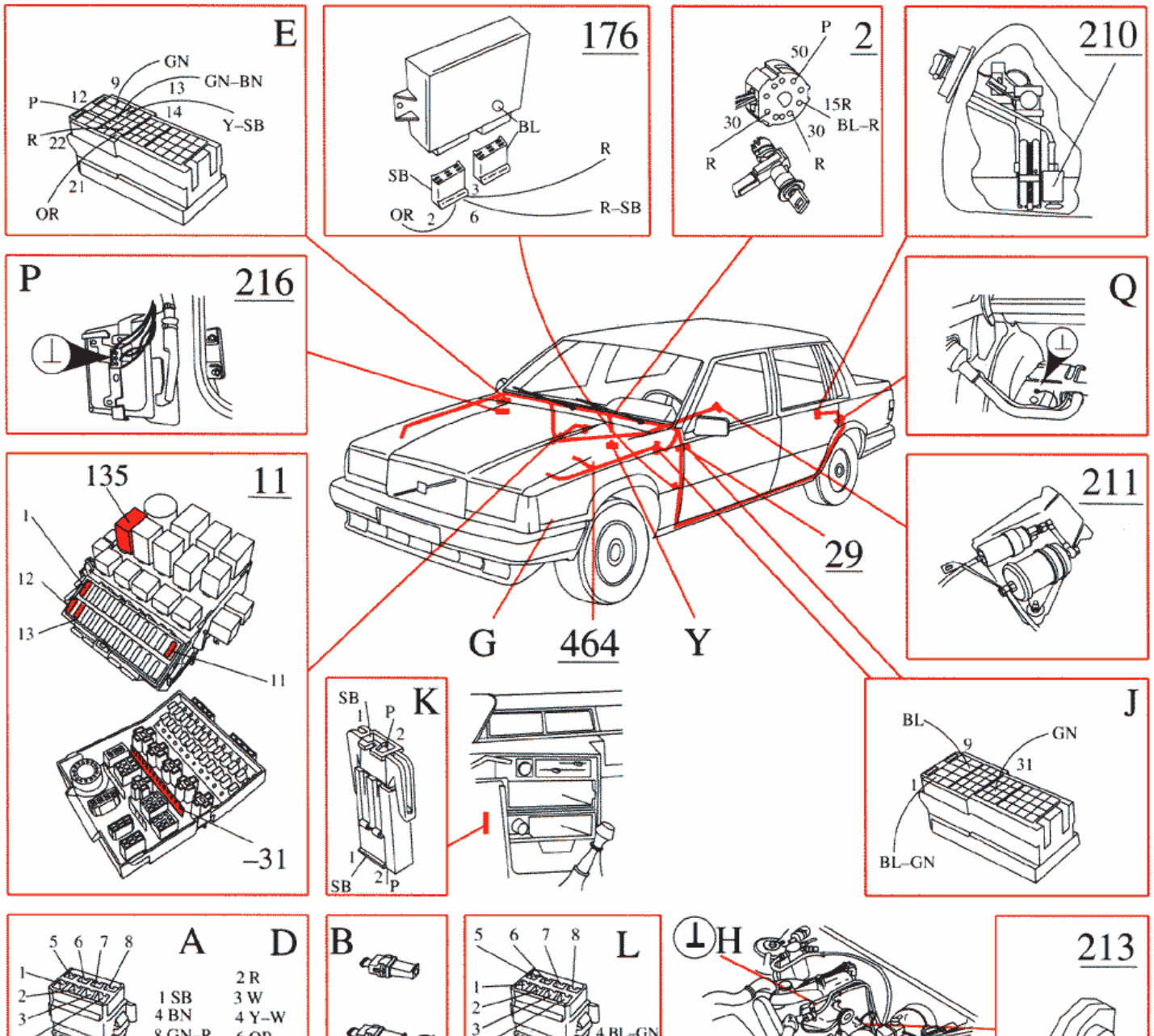
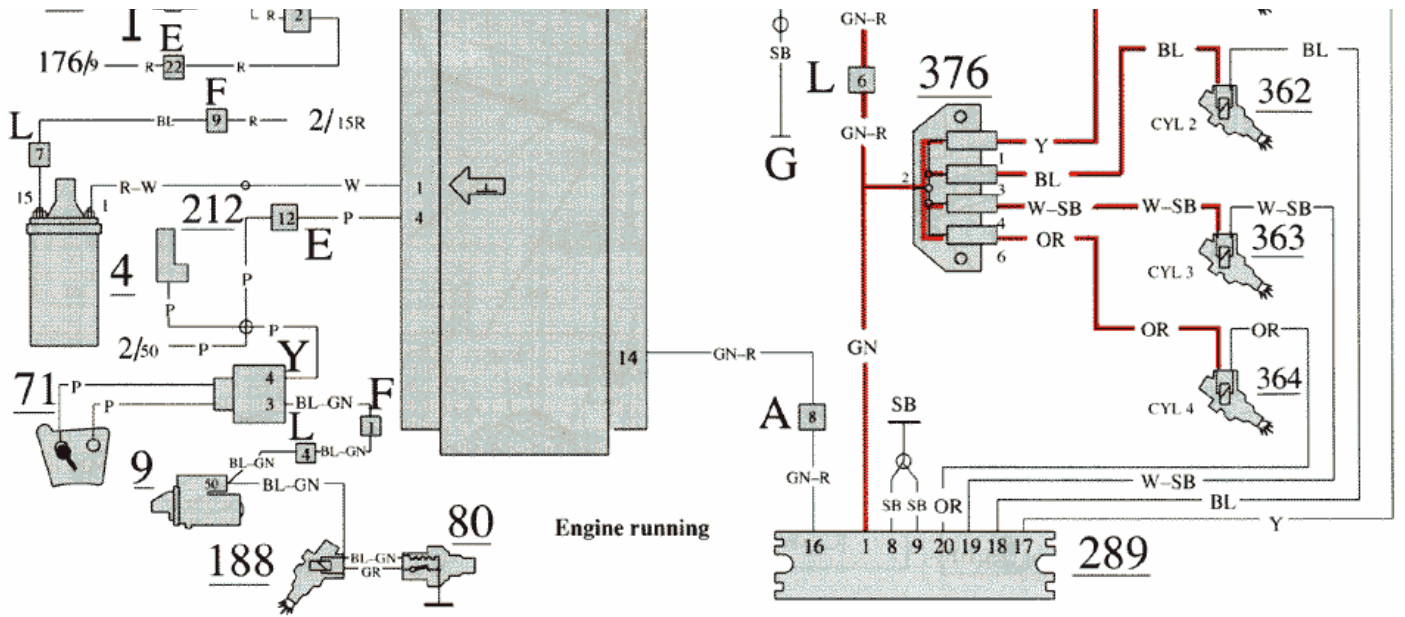



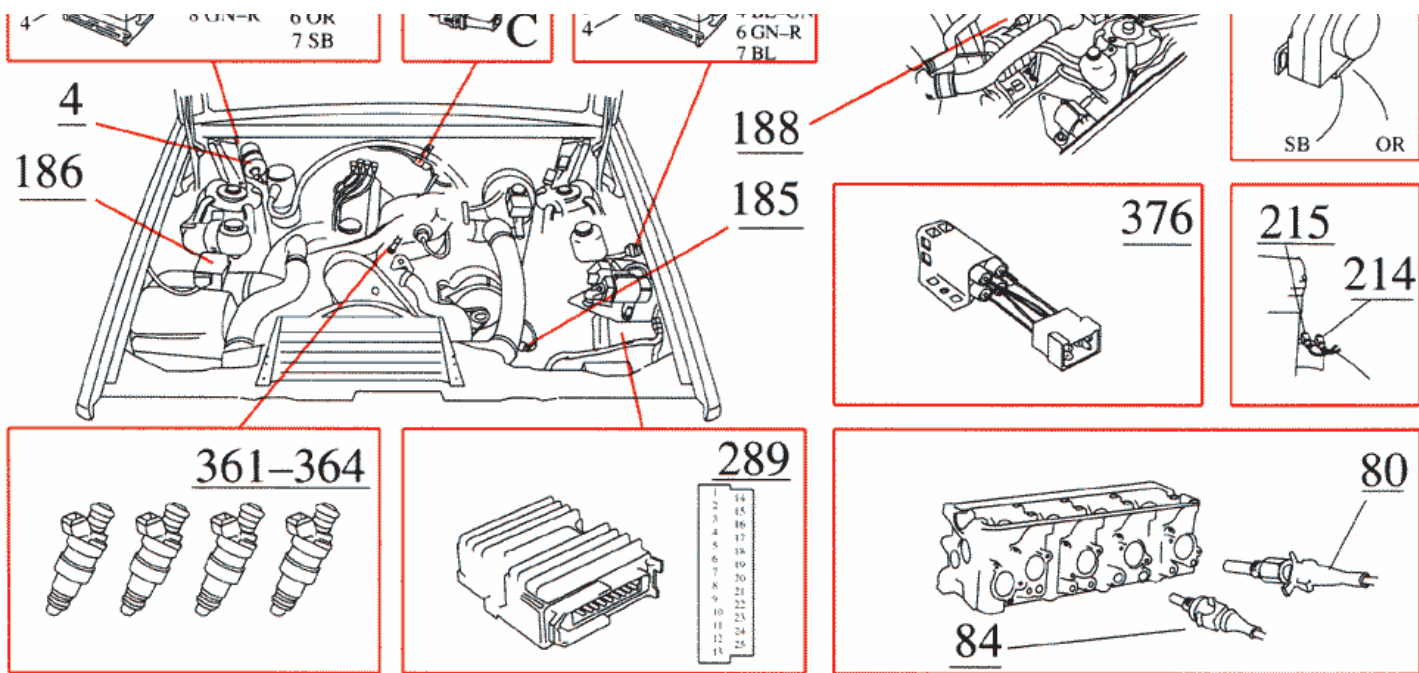

### LH-Jetronic 2.2, B230FT

- |   |   |   |
|---|---|---|
| 1 Battery                                       | 210 Tank pump                             | A Connector, right A-post                 |
| 2 Ignition switch                               | 211 Fuel pump                             | B Connector, left A-post                  |
| 4 Ignition coil                                 | 217 Control unit LH-Jetronic              | C Connector, right wheel housing          |
| 29 Positive terminal                            | 219 Test point Lambda sond system         | D Connector, right wheel housing          |
| 31 Ground point in electrical distribution unit | 220 Test point CIS-system                 | E Connector, left A-post                  |
| 76 Charge air overpressure switch               | 260 Ignition system control unit          | F Connector, left wheel housing           |
| 84 Coolant temperature sensor                   | 284 Air mass meter                        | G Connector, left wheel housing           |
| 135 Relay, fuel injection                       | 361-364 Injectors                         | H Ground point on inlet manifold          |
| 187 Lambda sond                                 | 376 Ballast resistor                      | J Ground point in boot                    |
| 196 Air control valve                           | 464 Relay, radio interference suppression | K Connector on bulkhead                   |
| 198 Throttle switch                             | 886 Bridge connector                      | L Connector, electrical distribution unit |
| 202 Climate unit                                |   | M Ground point, right A-post              |
|   |   | N Ground point, right wing                |
|   |   | O Connector, boot                         |
|   |   | P Connector (Japan, Australia)            |
|   |   | • Soldered joint                          |

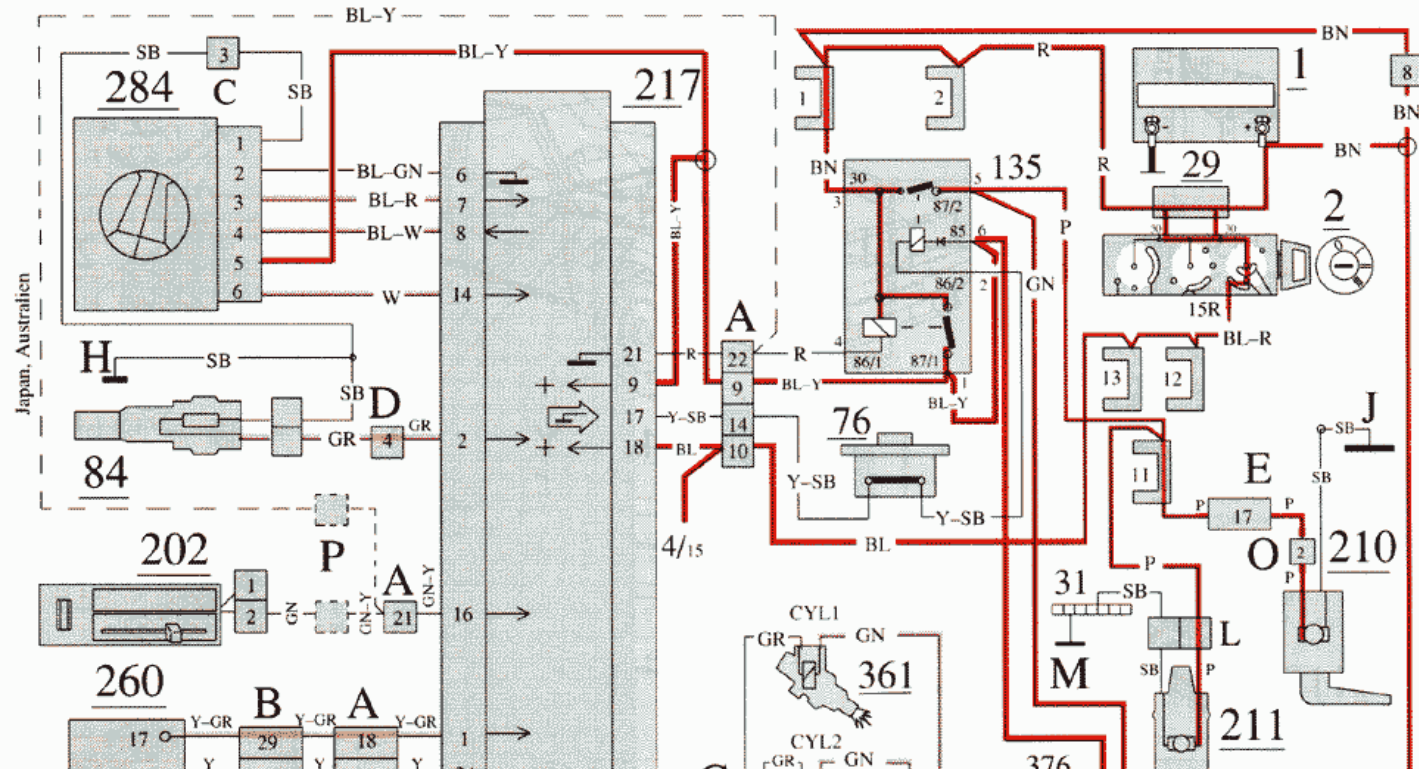

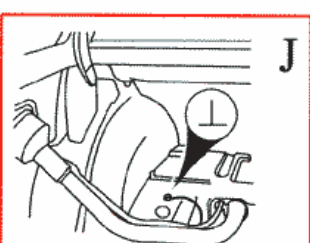
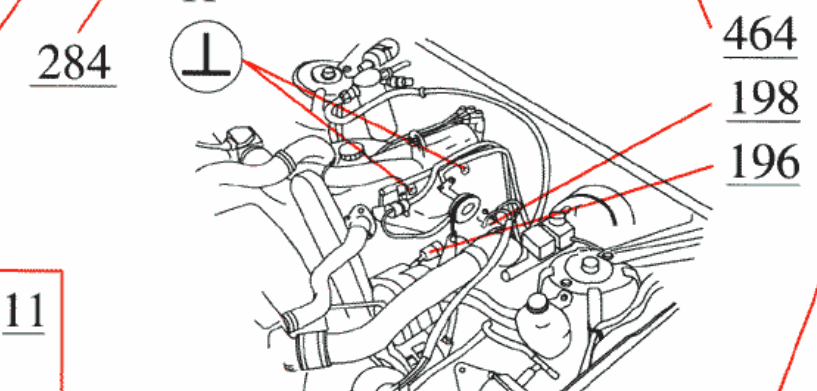
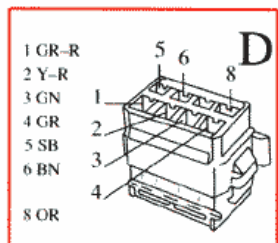
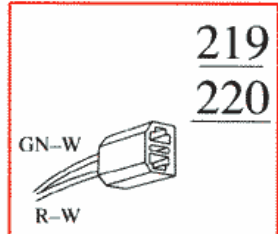
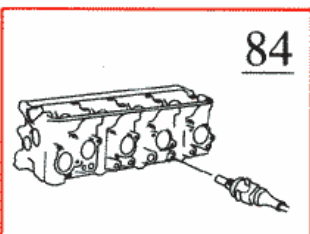
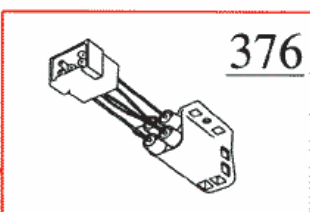
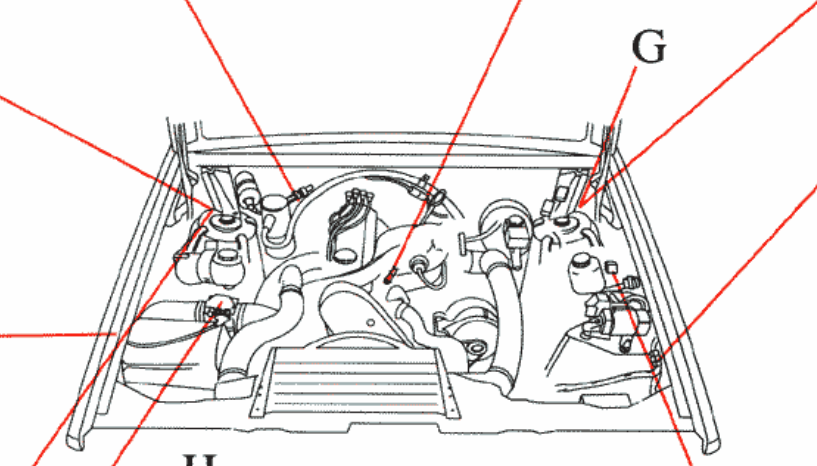
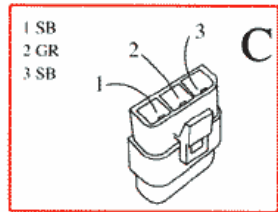
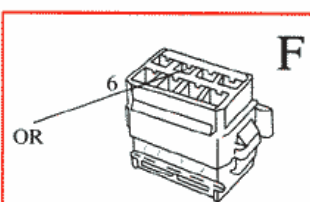
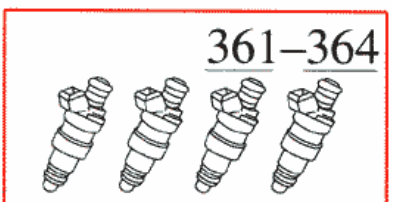
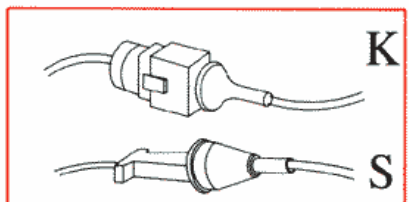
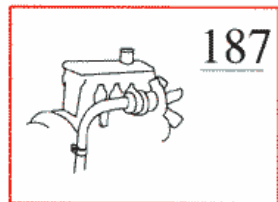
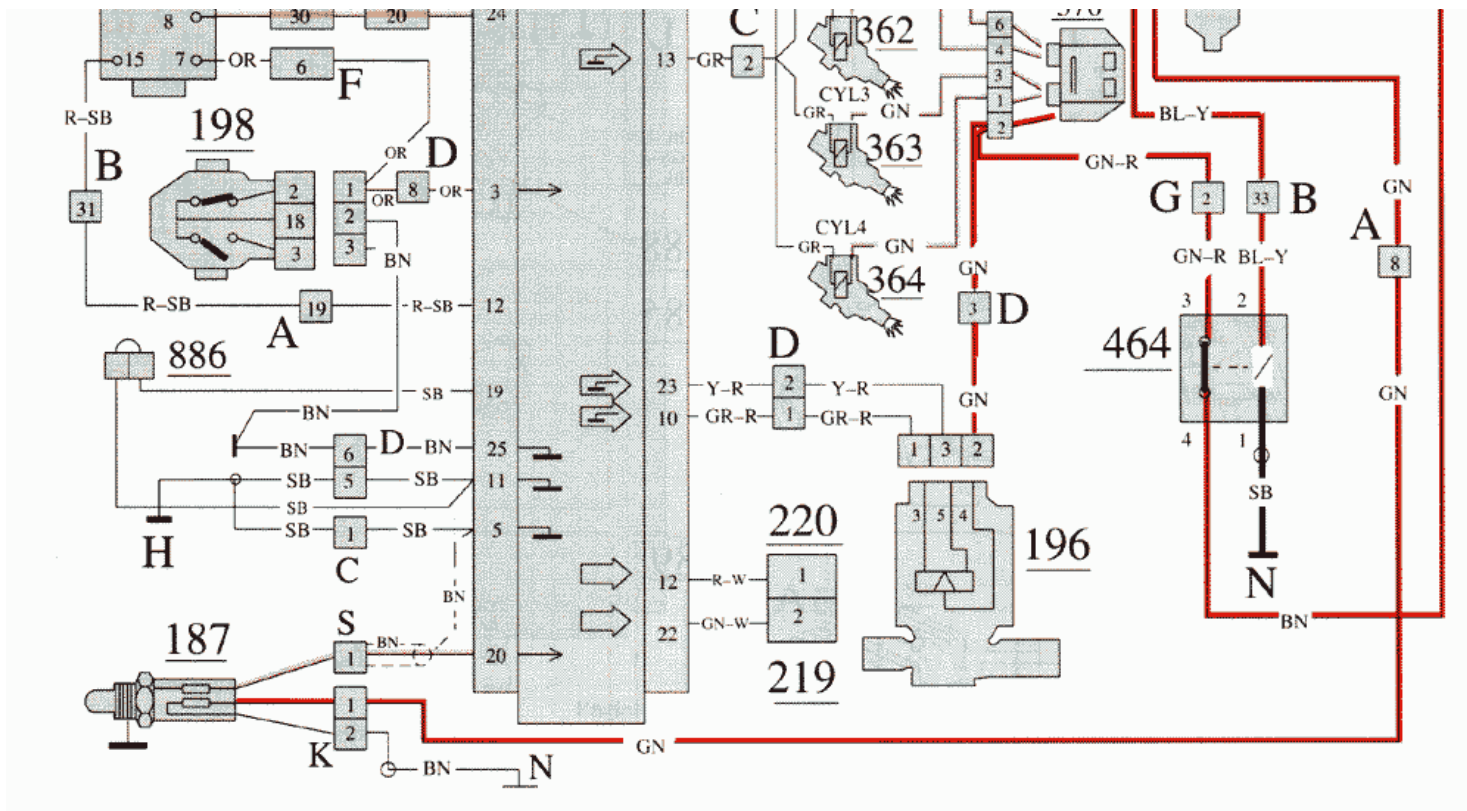



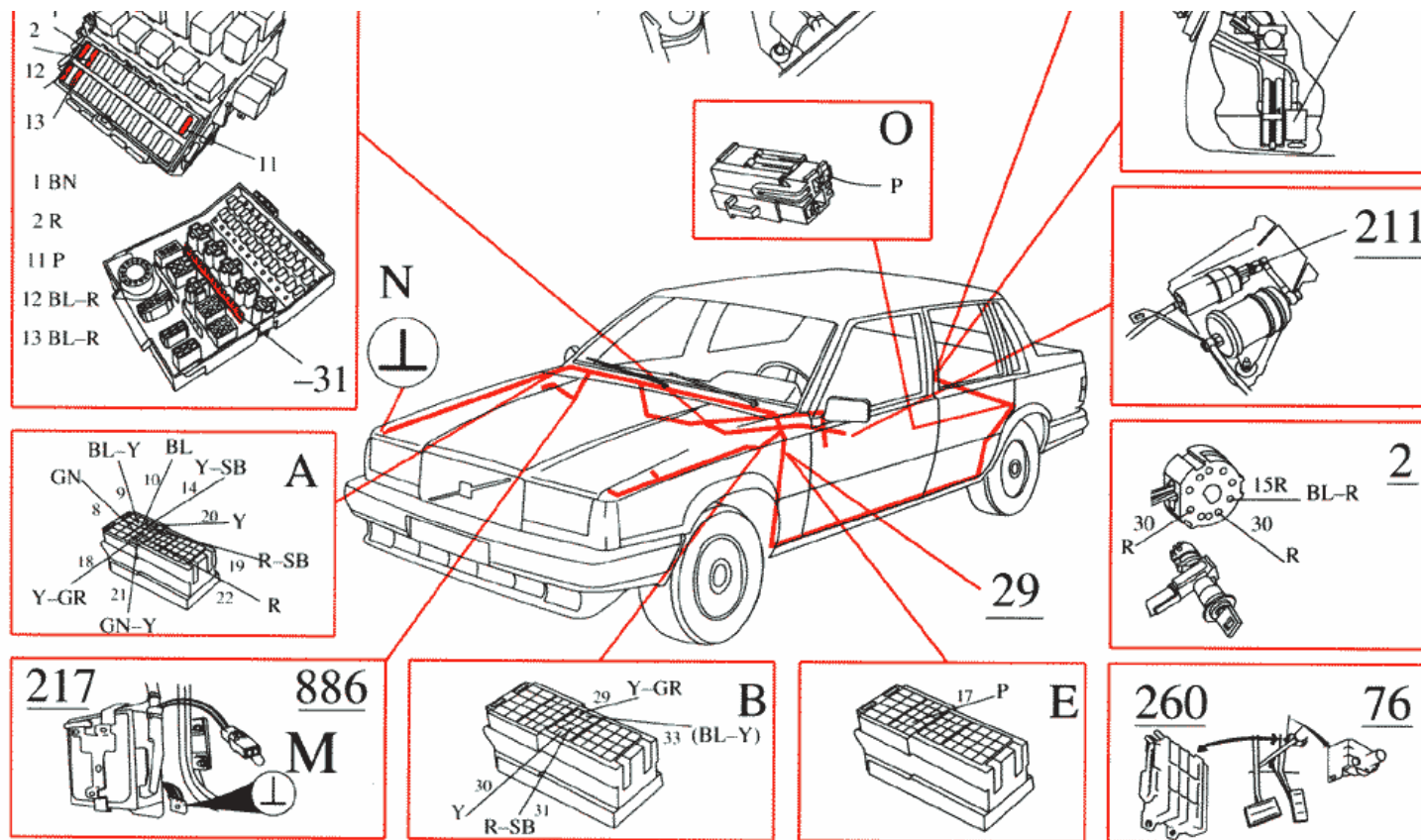

LH-Jetronic 2.4, B230F

- 1 Battery
- 2 Ignition switch
- 9 Starter motor
- 11 Electrical distribution unit
- 29 Positive terminal
- 31 Ground point in electrical distribution unit
- 81 Pressure sensor, AC
- 84 Coolant temperature sensor
- 85 Speedometer
- 135 Relay, fuel injection
- 187 Lambda sond
- 188 Cold start valve
- 196 Air control valve
- 198 Throttle switch

- 200 AC compressor
- 202 Climate unit
- 210 Tank pump
- 211 Fuel pump
- 212 Test socket
- 217 Control unit LH-Jetronic
- 260 Ignition system control unit
- 284 Air mass meter
- 361-364 Injectors
- 419 Power stage EZK
- 464 Relay, radio interference suppression
- 472 Control unit, LH Jetronic 2.4
- 482 Diagnostic socket
- 886 Bridge connector

- A Connector, right A-post
- B Connector, left A-post
- C Connector, right wheelhouse
- D Connector, right wheelhouse
- E Connector, left A-post
- F Connector, left wheelhouse
- H Ground point, inlet manifold
- J Ground point in boot
- K Connector on bulkhead
- L Connector, electrical distribution unit
- M Ground point, right A-post
- N Ground point, right wing
- O Connector in boot
- P Connector, electrical distribution unit
- Q 1 pole connector, right wheelhouse
- S Connector, bulkhead
- Soldered joint

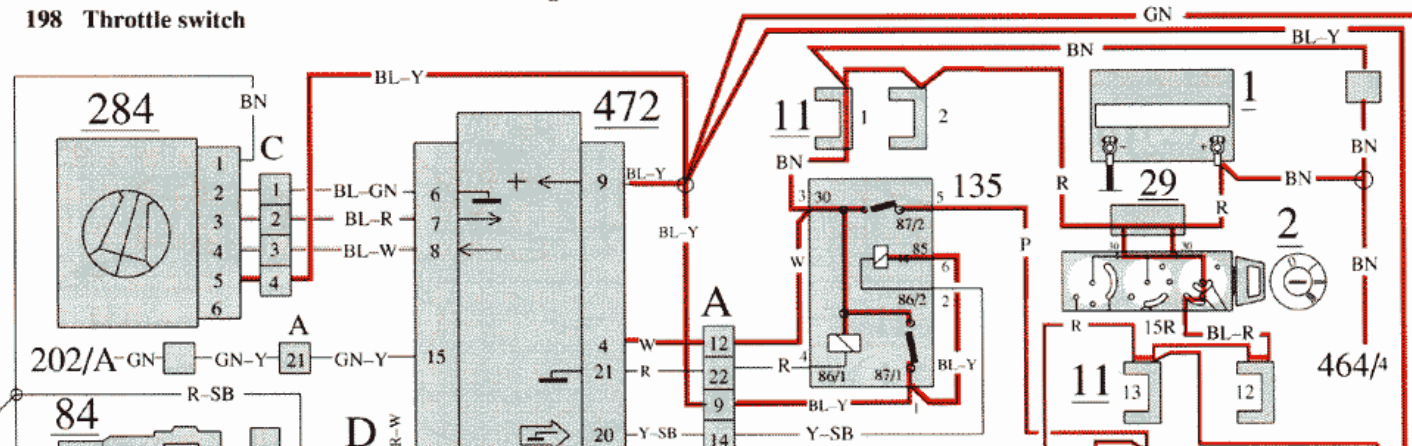

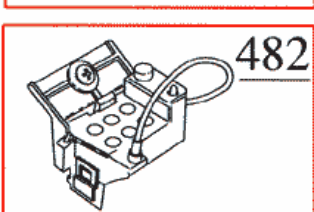
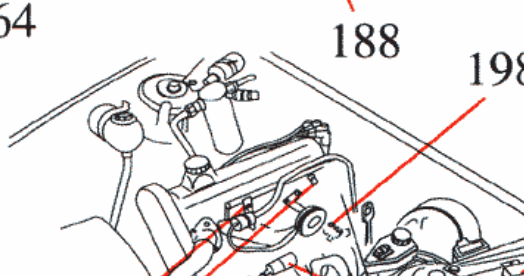
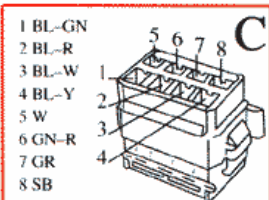
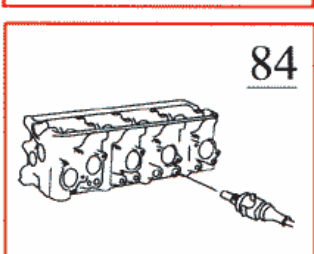
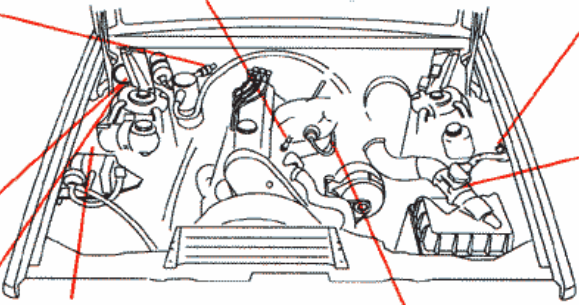
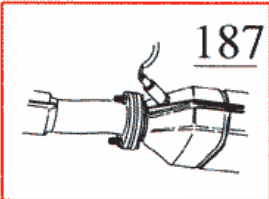
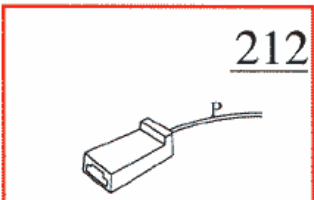
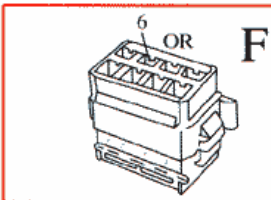
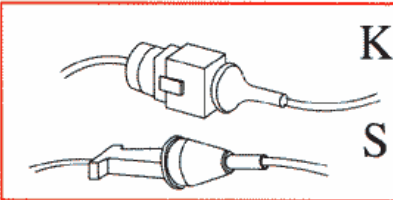
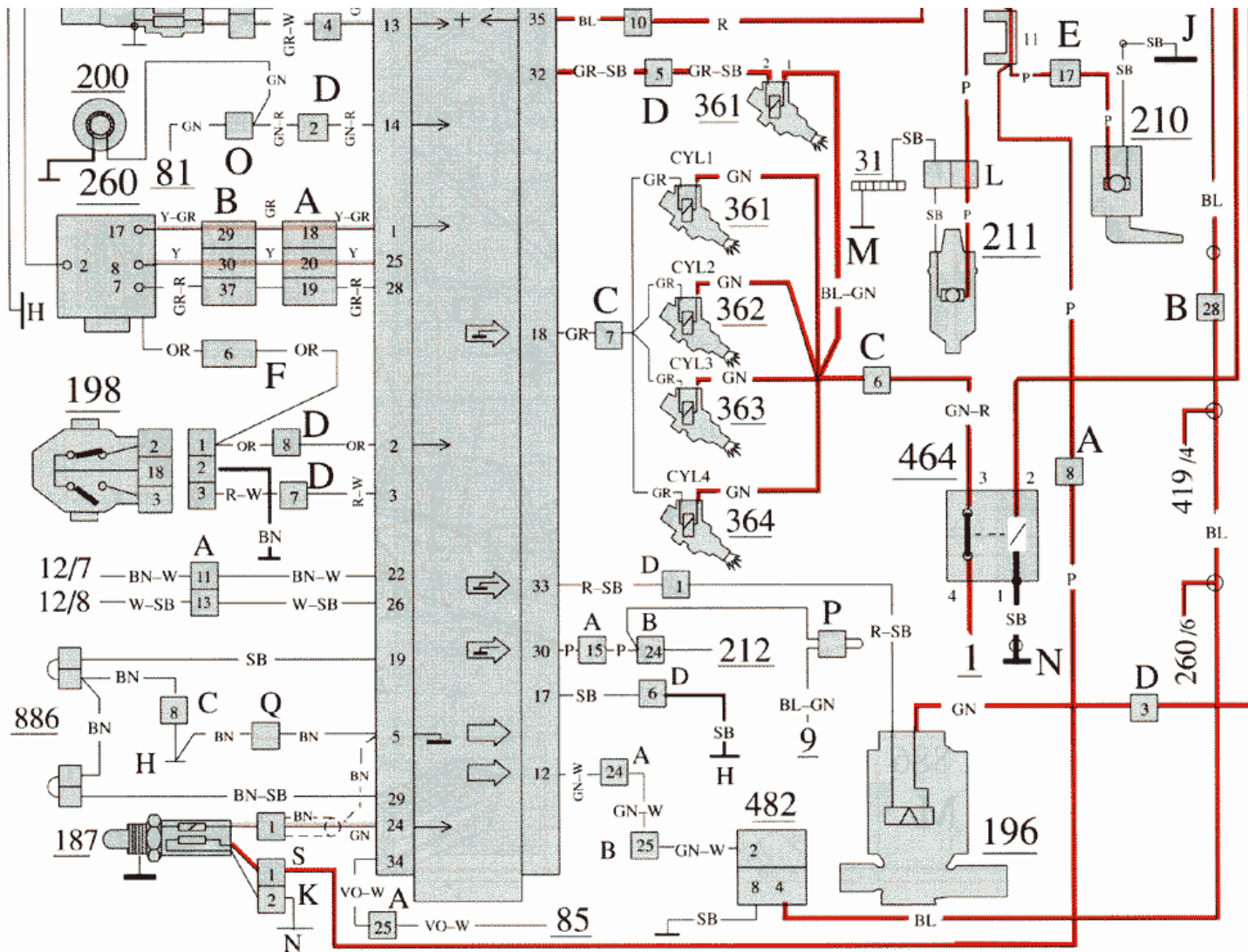



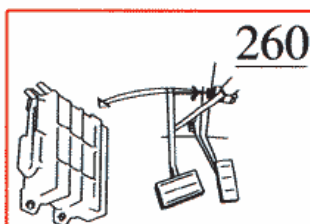
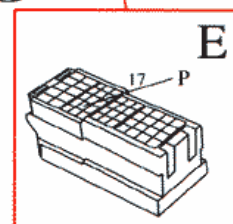
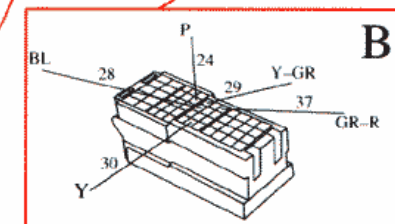
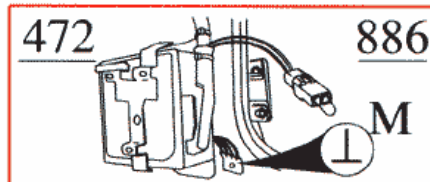
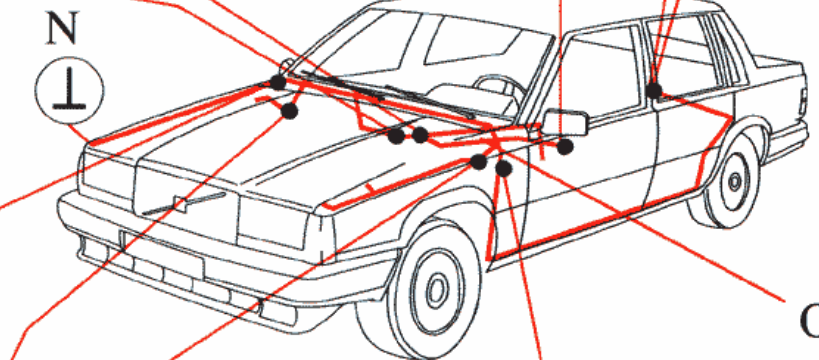
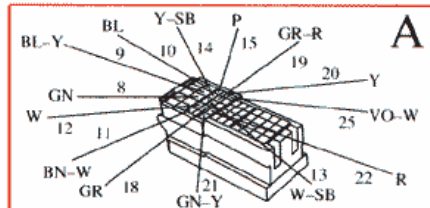
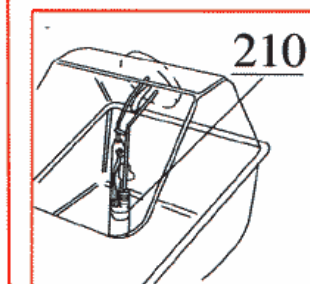
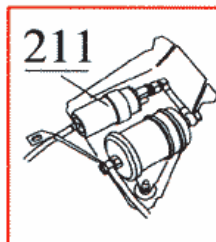
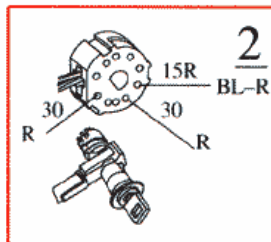
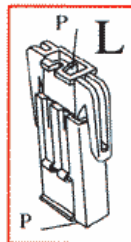
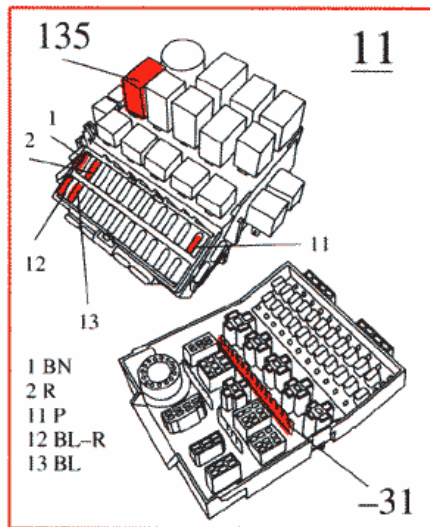
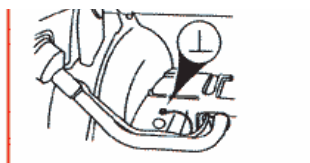
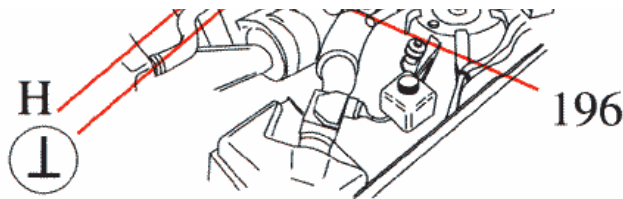
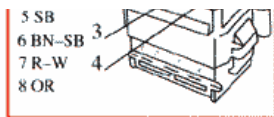

**LH-Jetronic 2.4, B234F, B204E**

- 1 Battery
- 2 Ignition switch
- 9 Starter motor
- 11 Electrical distribution unit
- 29 Positive terminal
- 31 Ground rail in electrical distribution unit
- 81 AC pressure sensor
- 84 Coolant temperature sensor
- 85 Speedometer
- 135 Relay, fuel injection
- 183 Solenoid valve (canister)(B234F)
- 187 Lambda sond (B234F)
- 196 Air control valve
- 198 Throttle switch

- 200 AC compressor
- 202 Climate control
- 210 Tank pump
- 211 Fuel pump
- 212 Test socket
- 260 Control unit, ignition system
- 284 Air mass meter
- 361-364 Injectors
- 419 Power stage EZK
- 464 Relay, radio interference suppression
- 472 Control unit, LH-Jetronic 2.4
- 482 Diagnostic socket
- 886 Bridge connector

- A Connector, right A-post
- B Connector, left A-post
- C Connector, right suspension tower
- D Connector, right suspension tower
- E Connector, left A post
- F Connector, left suspension tower
- H Ground point, inlet manifold
- J Ground point in boot
- K Connector at bulkhead
- L Connector in electrical distribution unit
- M Ground point, right A-post
- N Ground point, right front wing
- O Connector at bulkhead
- P Connector in electrical distribution unit
- Q Connector, right suspension tower, 1-pole
- S Connector at bulkhead
- o Soldered joint

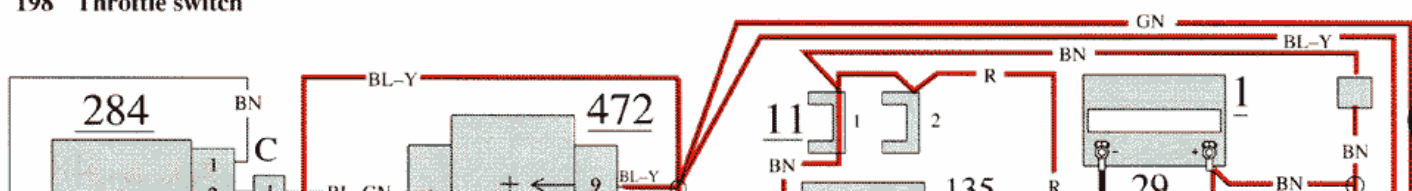

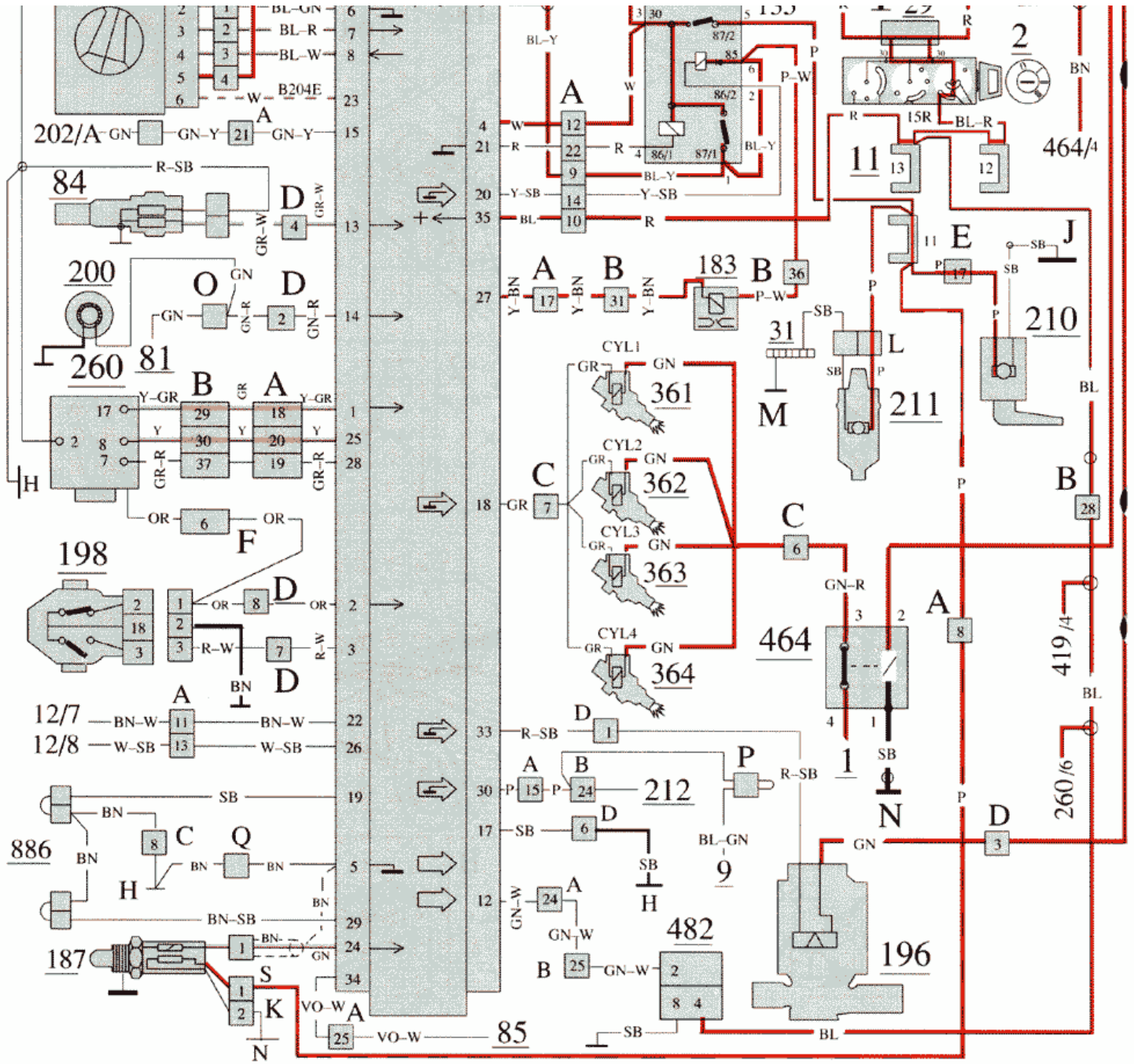



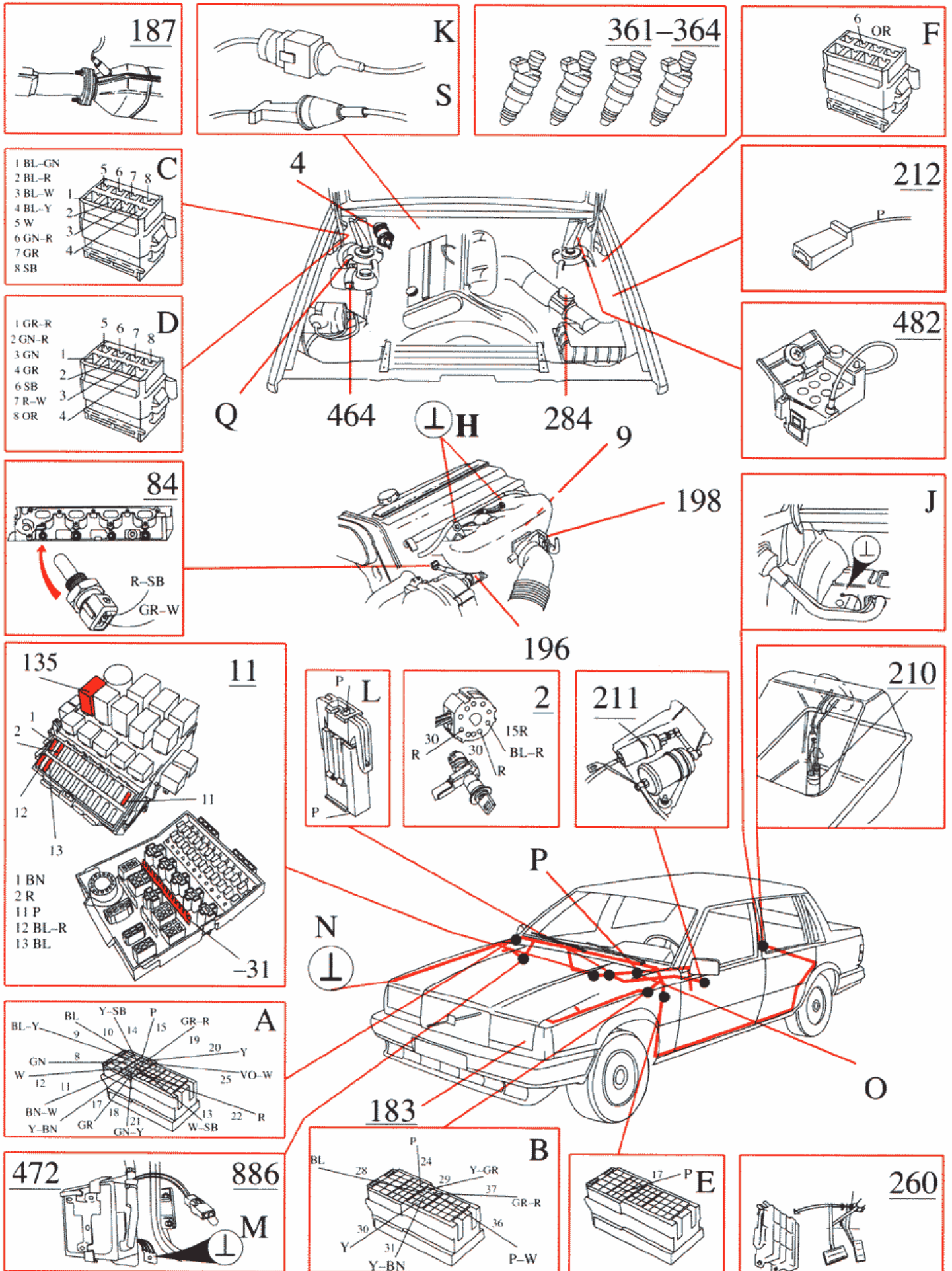

# Regina, B234F, USA Federal

- 1 Battery
- 2 Ignition switch
- 9 Starter motor
- 11 Fusebox
- 12/7 Connection, engine check lamp
- 12/8 Connection, shift indicator lamp
- 29 Positive terminal
- 31 Ground rail in electrical distribution unit
- 81 AC pressure sensor
- 84 Coolant temperature sensor
- 85 Speedometer
- 135 Relay, fuel injection
- 185 Air intake temperature sensor
- 187 Lambda sond
- 188 Cold start valve

- 196 Air control valve
- 198 Throttle switch
- 200 AC compressor
- 202 Climate control
- 210 Fuel pump
- 212 Test socket
- 260 Control unit, ignition system
- 361-364 Injectors
- 419 Power stage Rex i
- 440 Pressure sensor, inlet manifold
- 464 Relay, radio interference suppression
- 473 Control unit, Regina
- 482 Diagnostic socket

- A Connector, right A-post
- B Connector, left A-post
- C Connector, right suspension tower
- D Connector, right suspension tower
- E Connector, left A post
- F Connector, left suspension tower
- H Ground point, inlet manifold (signal ground)
- J Ground point in boot
- K Connector at bulkhead
- N Ground point, right front wing
- O Connector at bulkhead
- P Connector in electrical distribution unit
- Q Connector, right suspension tower, 4-pole
- R Ground point, inlet manifold (power ground)
- S Connector at bulkhead, 1-pole
- Soldered joint

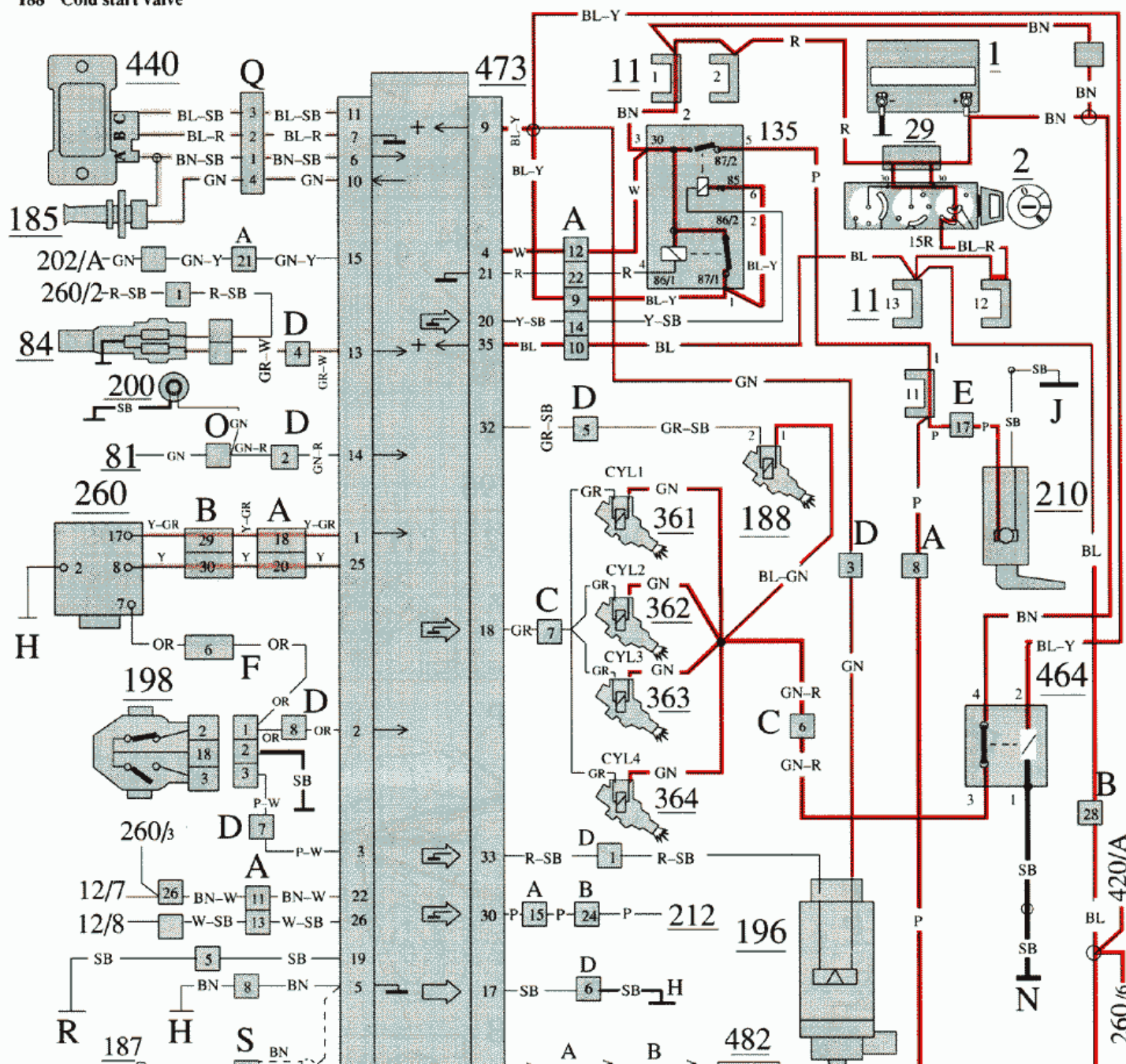



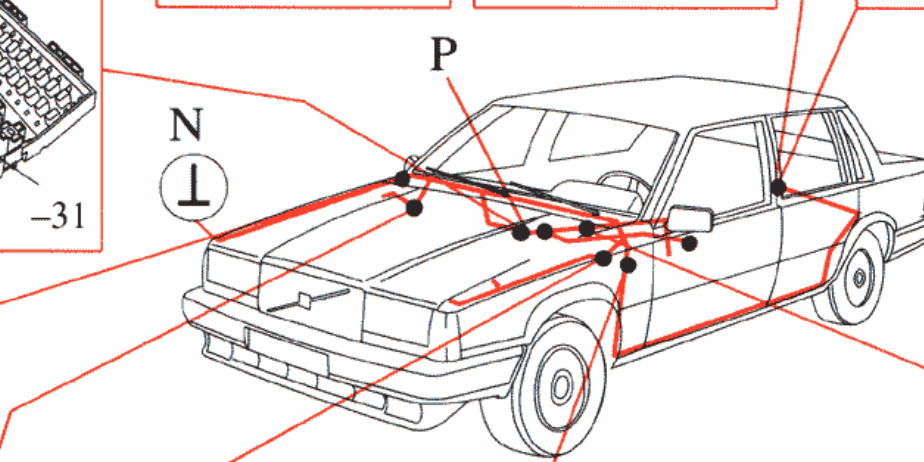
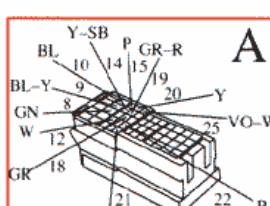
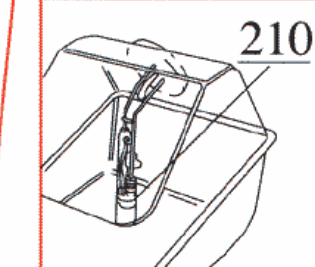
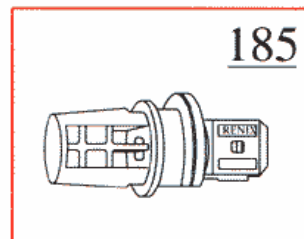
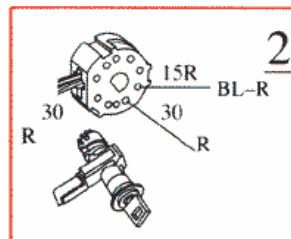
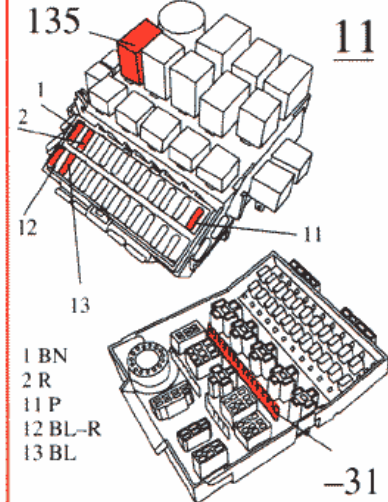
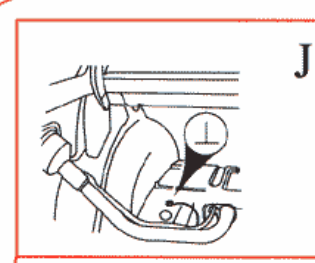
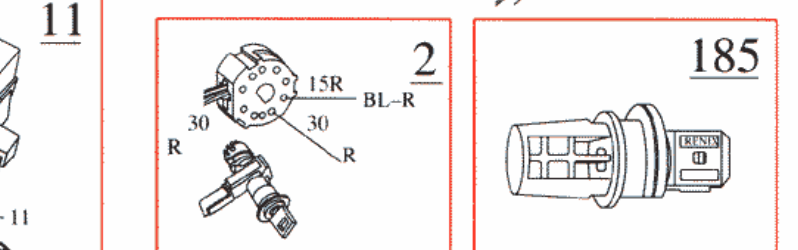
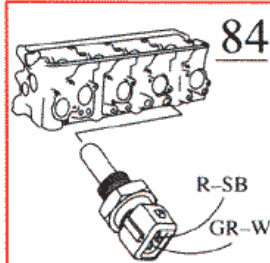
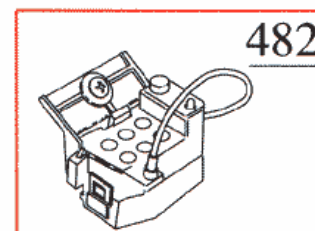
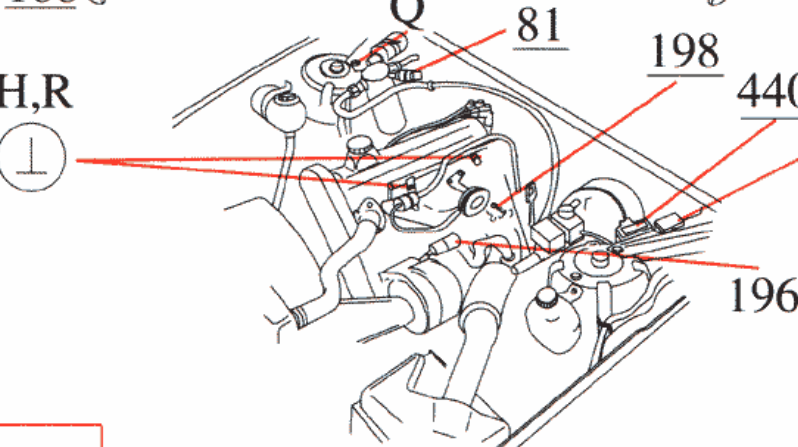
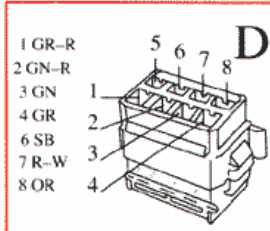
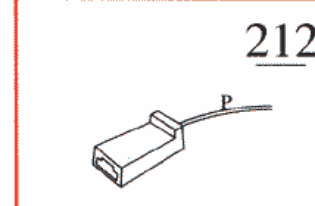
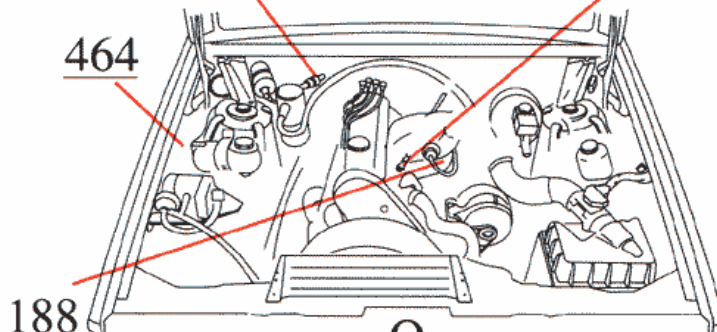
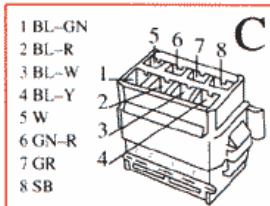
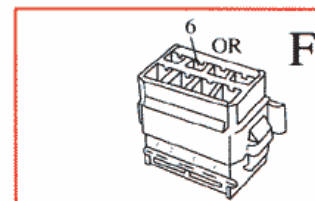
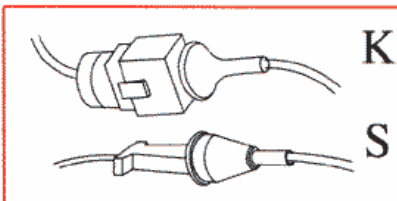
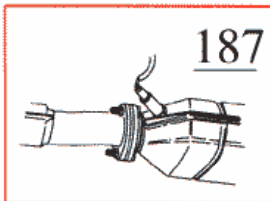
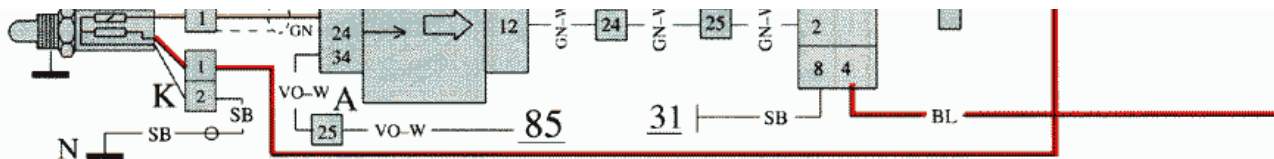

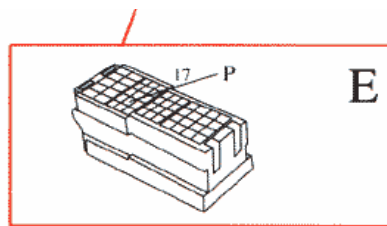
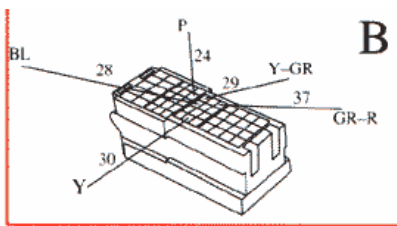
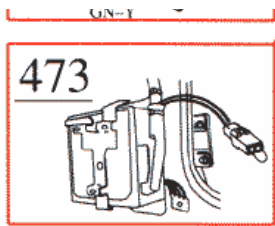

### EZ 116K Ignition system, B230F

- |   |   |
|---|---|
| <ul style="list-style-type: none"> <li>1 Battery</li> <li>2 Ignition switch</li> <li>4 Ignition coil</li> <li>5 Distributor</li> <li>6 Spark plug</li> <li>11 Fusebox</li> <li>12 Instrument connection</li> <li>29 Positive terminal</li> <li>31 Ground rail in electrical distribution unit</li> <li>84 Temperature sensor</li> <li>198 Throttle switch</li> <li>218 Knock sensor</li> <li>260 Control unit, ignition system</li> <li>276 EGR converter (USA, California)</li> <li>413 Impulse sensor</li> <li>419 Power stage</li> <li>472 Control unit, fuel system</li> <li>482 Diagnostic socket</li> </ul> | <ul style="list-style-type: none"> <li>A Connector, right A-post</li> <li>B Connector, left A-post</li> <li>C Connector, left suspension tower</li> <li>D Ground point, inlet manifold</li> <li>E Connector at bulkhead</li> <li>F Connector, left suspension tower</li> <li>G Connector, right suspension tower</li> <li>H Connector, left suspension tower</li> <li>J Connector, left suspension tower, 2-pole (moisture sealed)</li> </ul> |
|---|---|

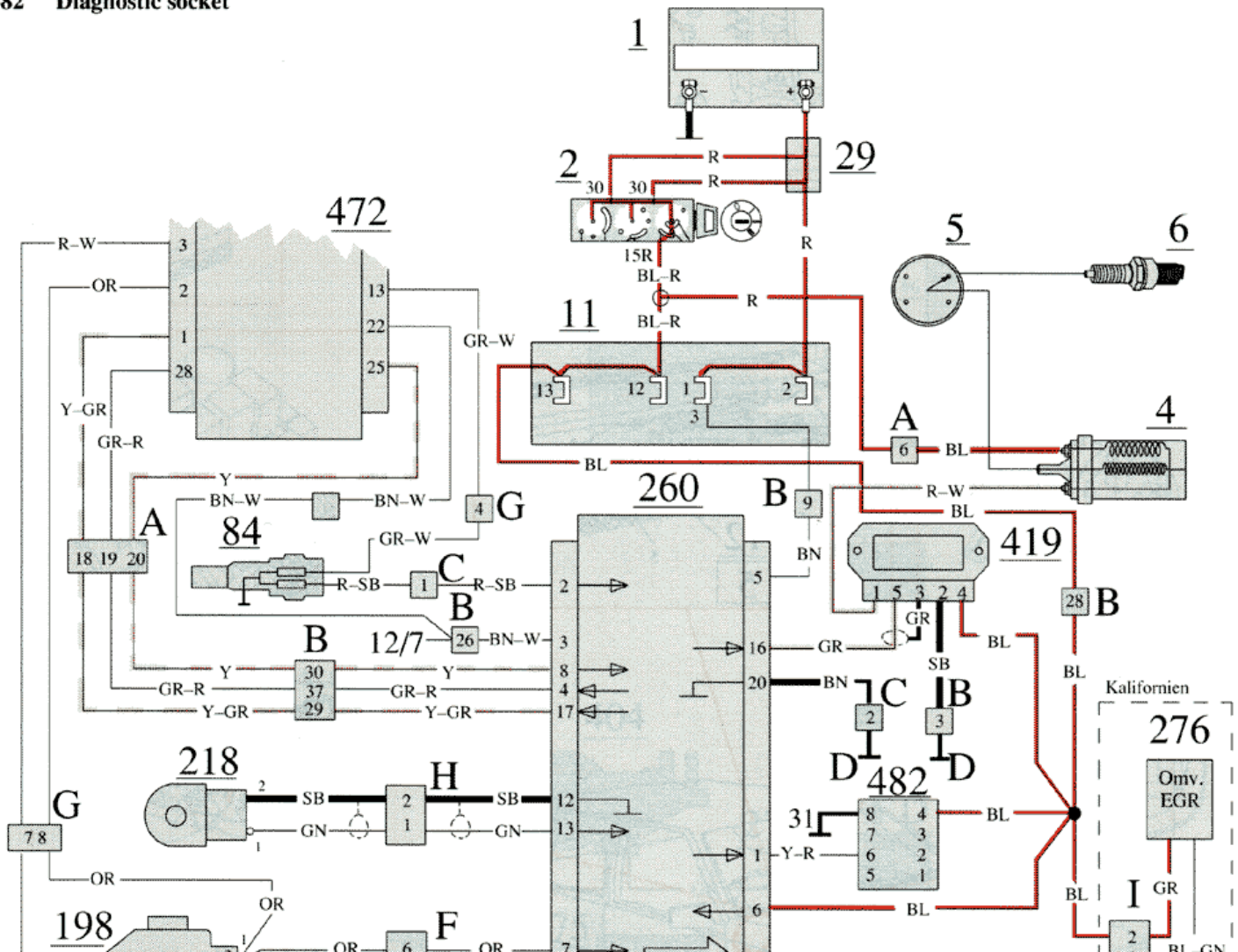



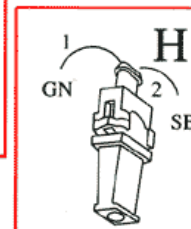
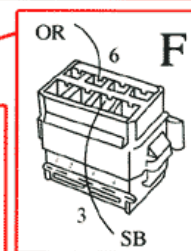
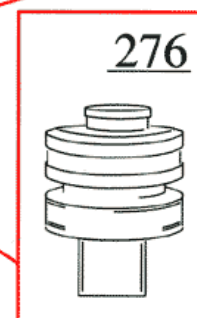
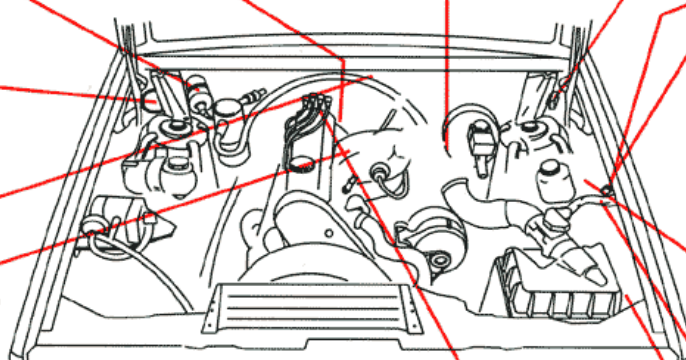
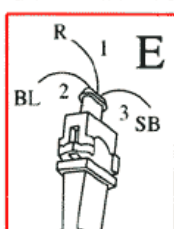
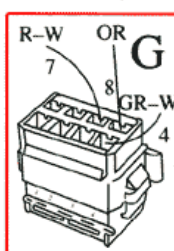
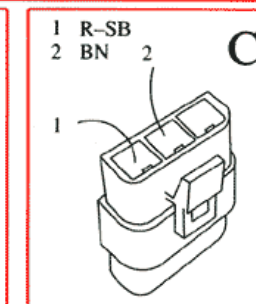
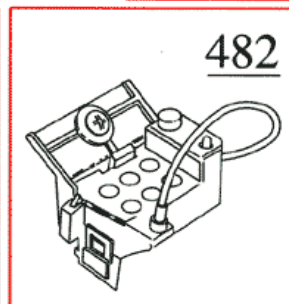
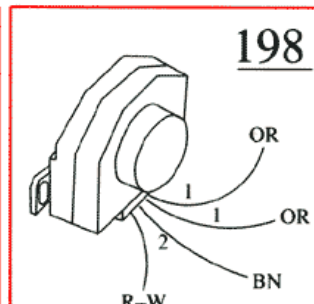
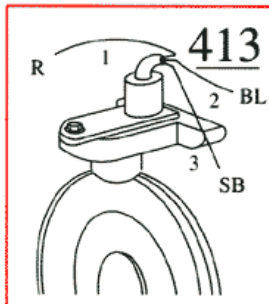
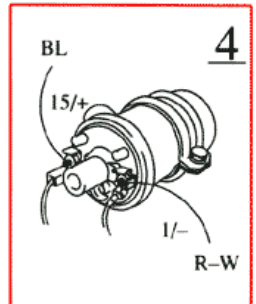
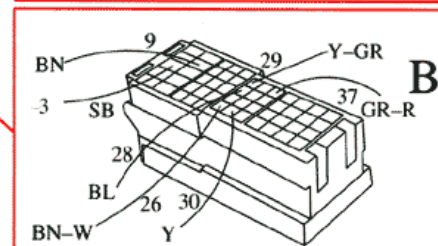
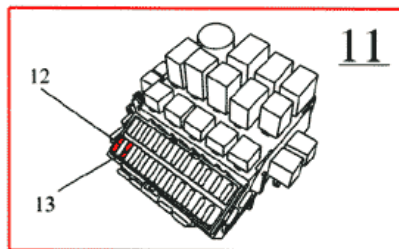
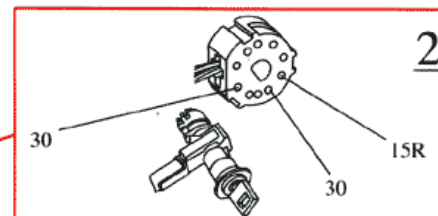
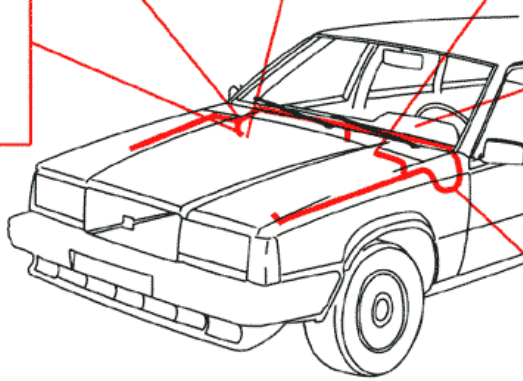
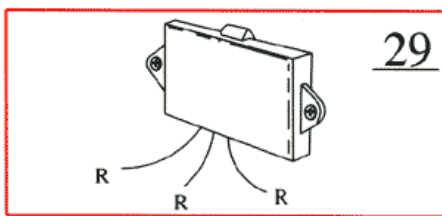
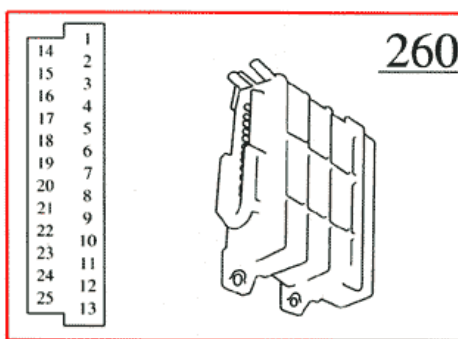
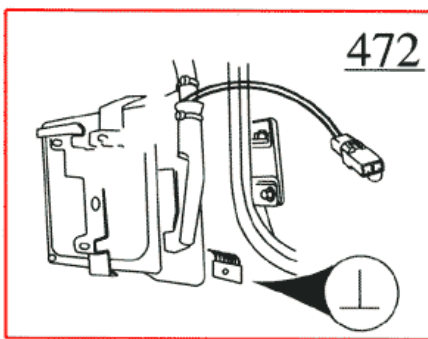
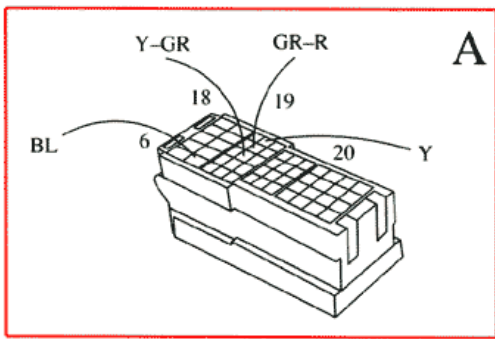
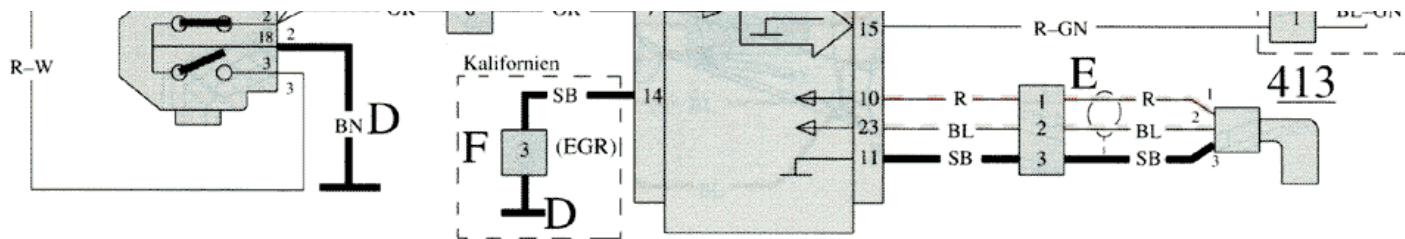

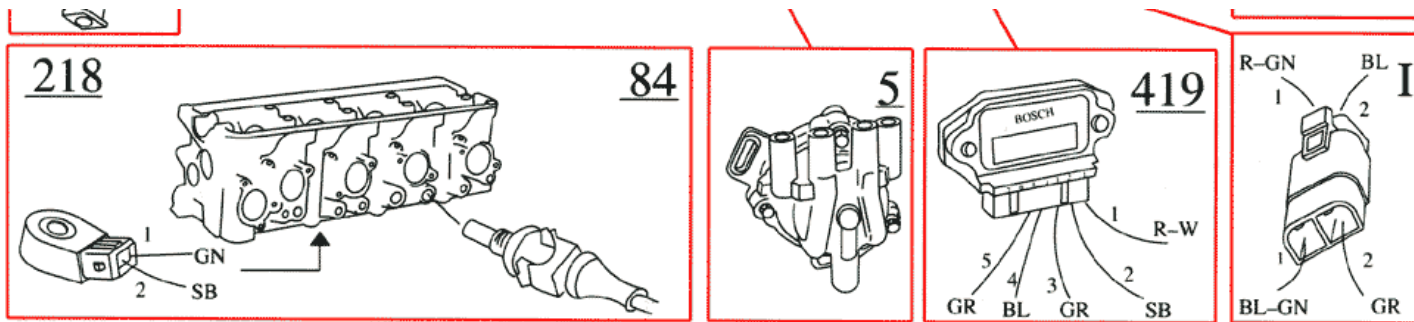

**EZ 116K Ignition system, B234F, B204E**

- 1 Battery
- 2 Ignition switch
- 4 Ignition coil
- 5 Distributor
- 6 Spark plug
- 11 Fusebox
- 29 Positive terminal
- 31 Ground rail in electrical distribution unit
- 84 Temperature sensor
- 86 Tachometer
- 198 Throttle switch
- 218 Knock sensor
- 260 Control unit, ignition system
- 413 Impulse sensor
- 419 Power stage
- 472 Control unit, fuel system
- 482 Diagnostic socket

- A Connector, right A-post
- B Connector, left A-post
- C Connector, left suspension tower
- D Ground point, inlet manifold
- E Connector at bulkhead
- F Connector, left suspension tower
- G Connector, right suspension tower
- H Connector, left suspension tower
- I Ground point, right A-post
- K Connector

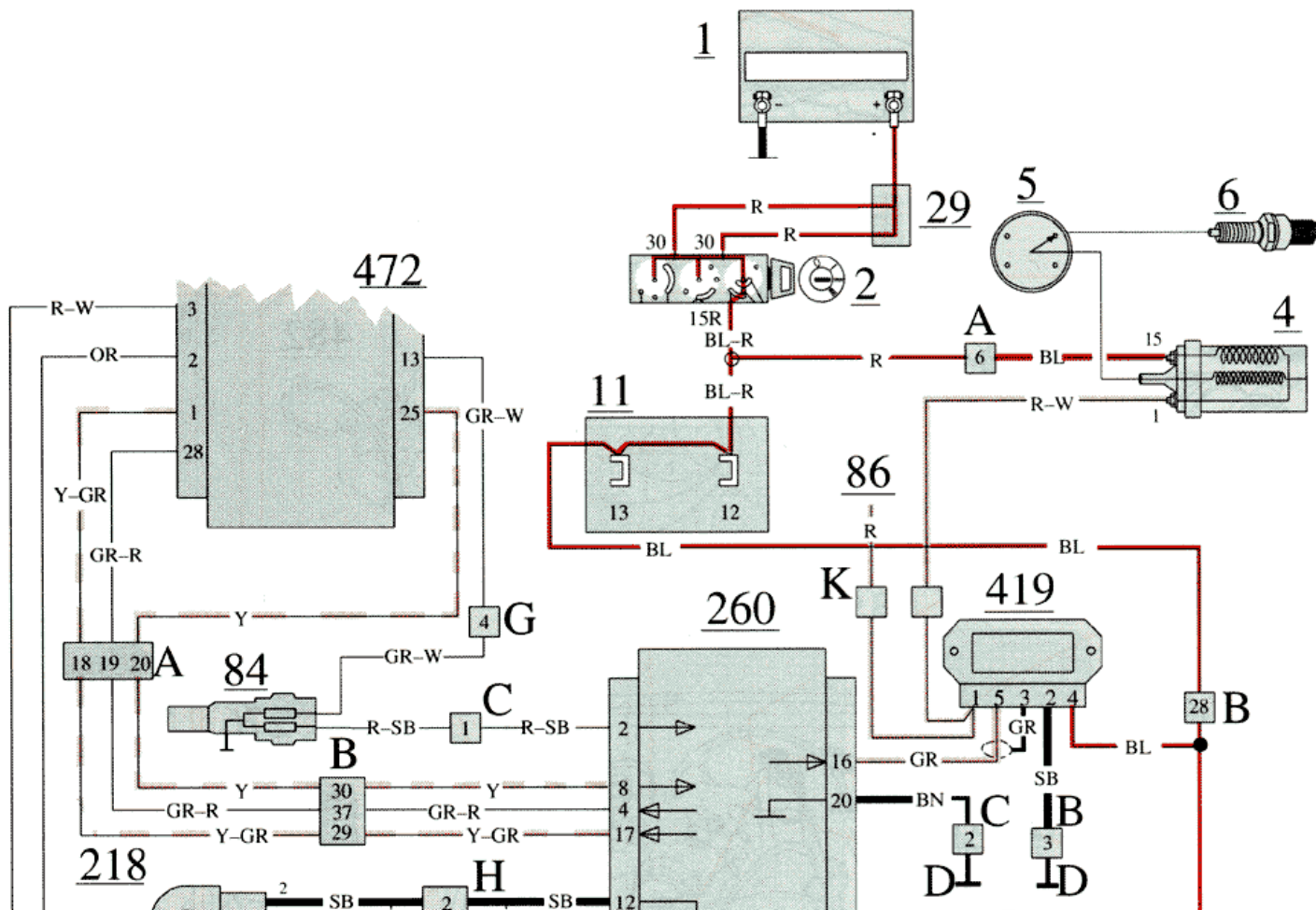



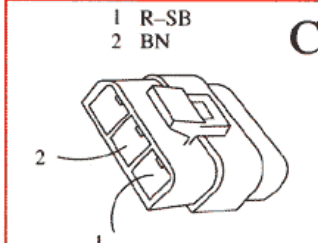
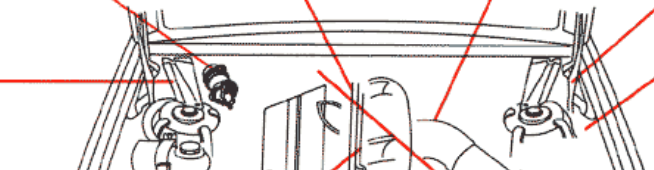
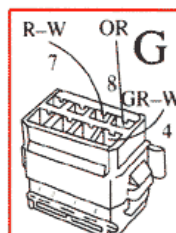
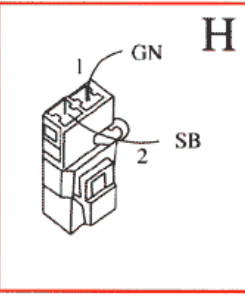
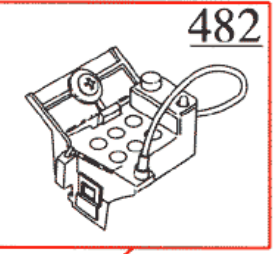
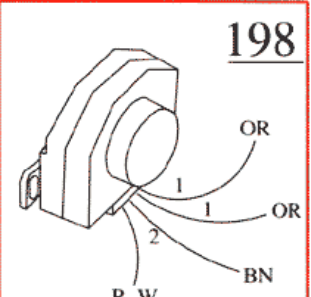
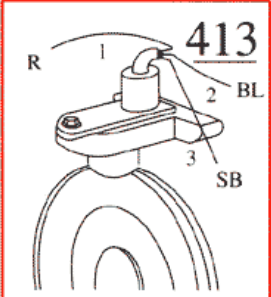
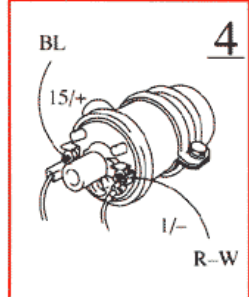
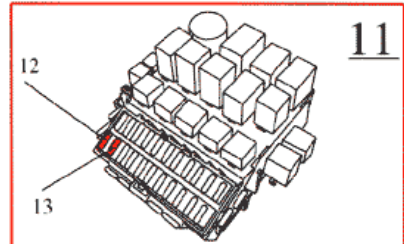
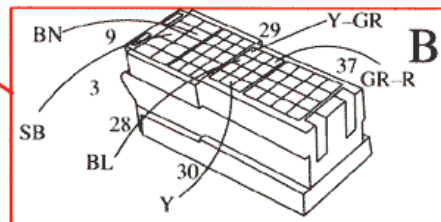
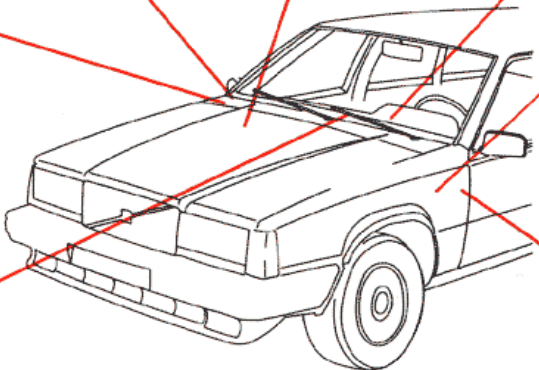
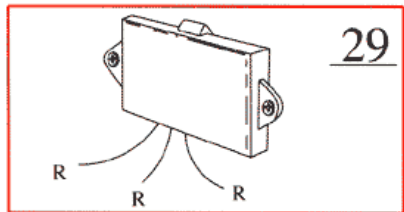
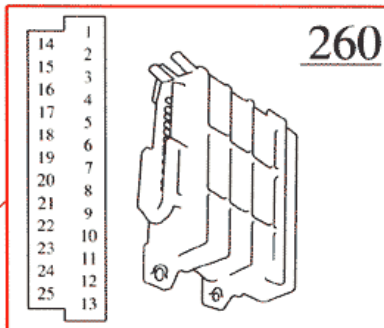
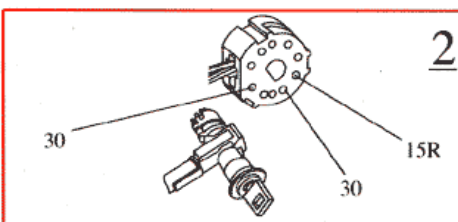
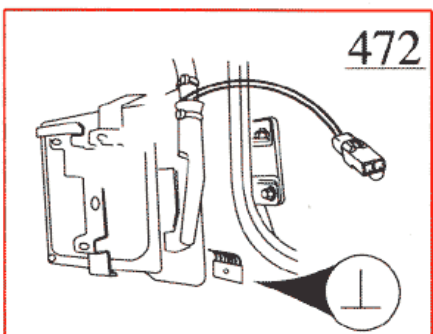
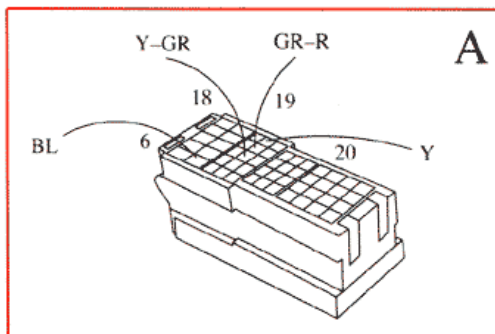
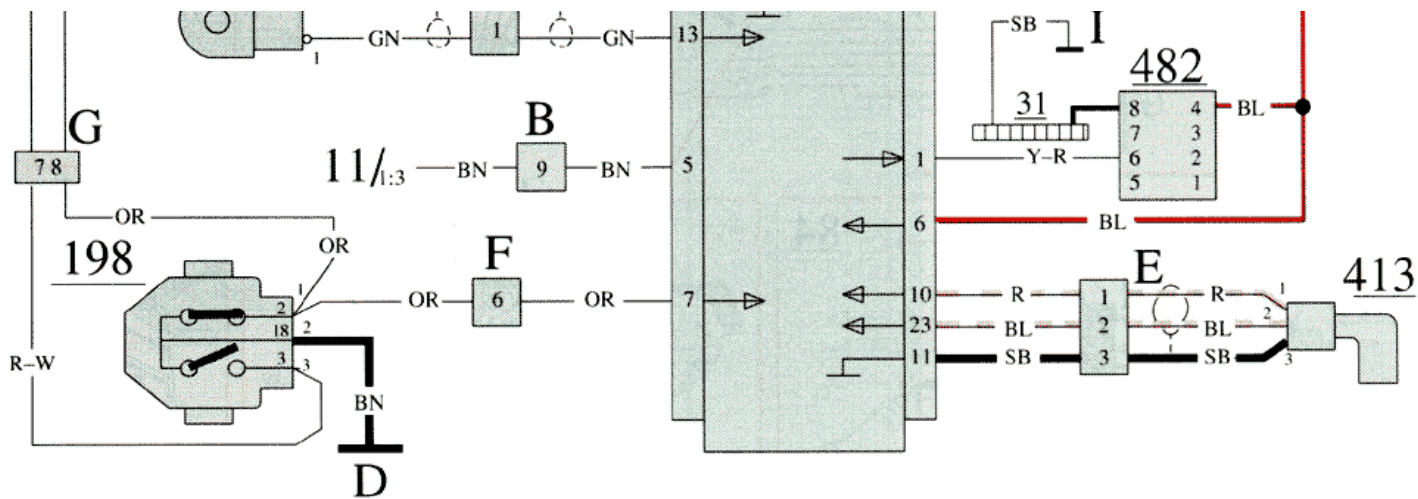

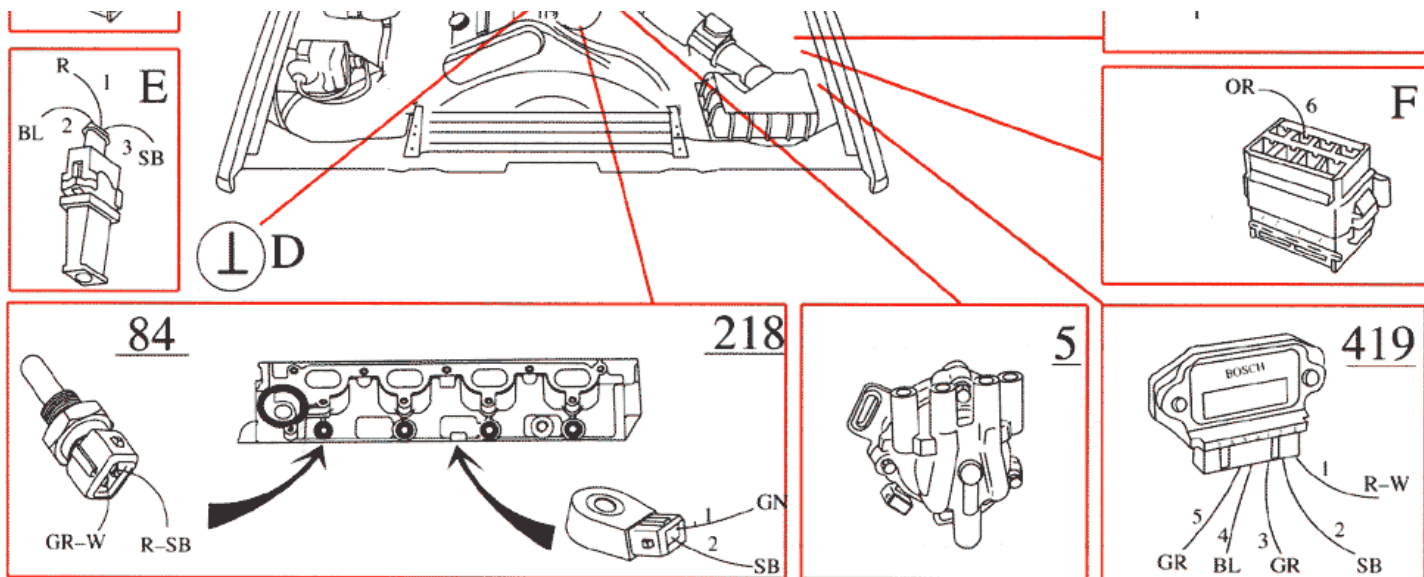

### EZ 117K Ignition system, B230FT

- |                       |                                    |                                     |
|-----------------------|------------------------------------|-------------------------------------|
| 1 Battery             | 198 Throttle switch                | A Connector, right A-post           |
| 2 Ignition switch     | 200 AC compressor solenoid         | B Connector, left A-post            |
| 4 Ignition coil       | 202 Climate control panel          | C Connector, left suspension tower  |
| 5 Distributor         | 217 Fuel system control unit       | D Ground, intake manifold           |
| 6 Spark plug          | 218 Knock sensor                   | E Connector, right suspension tower |
| 11 Fusebox            | 260 Control unit                   | F Connector, left suspension tower  |
| 29 Positive terminal  | 267 Test socket                    |                                     |
| 81 AC pressure sensor | 293 Relay, idle speed compensation |                                     |
| 86 Tachometer         | 419 Power stage                    |                                     |

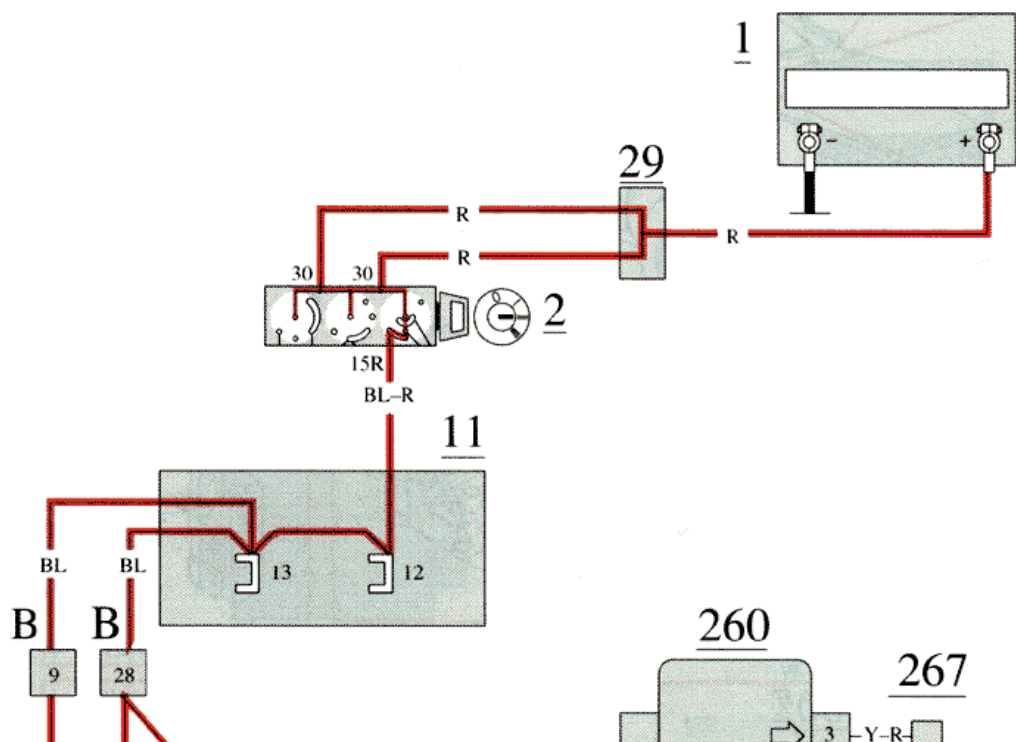



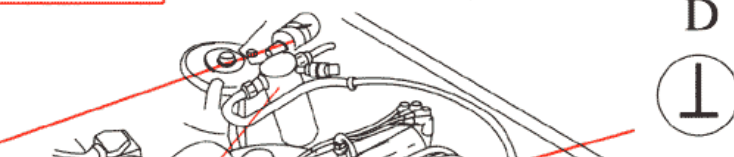
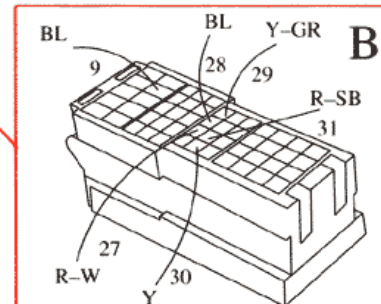
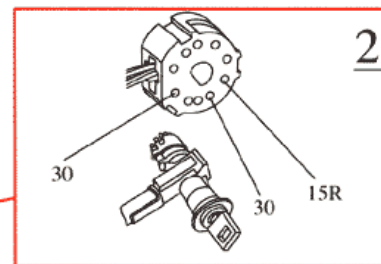
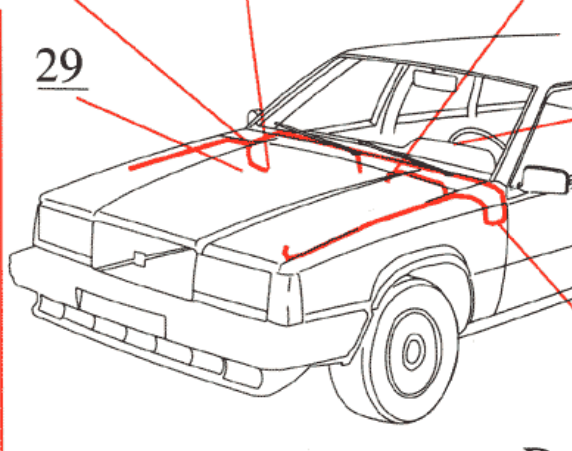
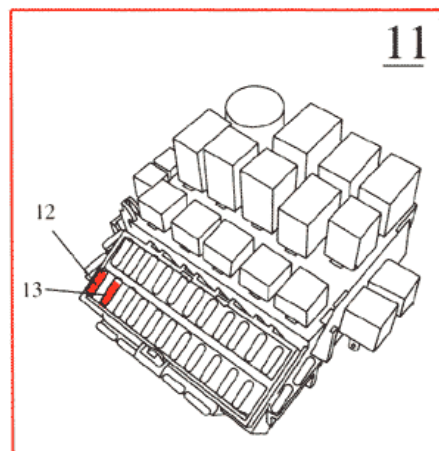
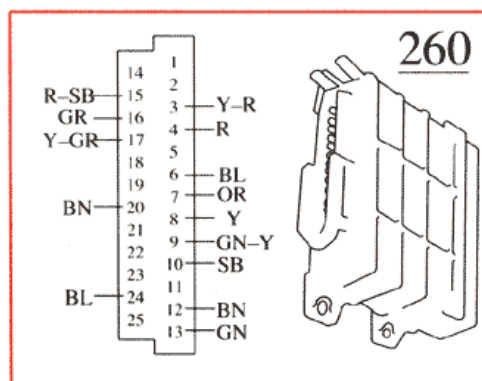
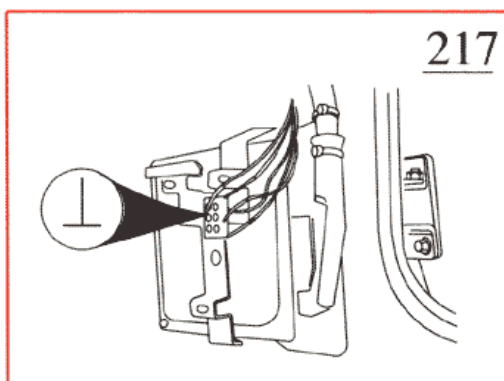
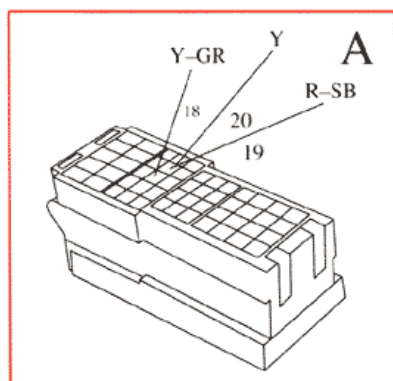
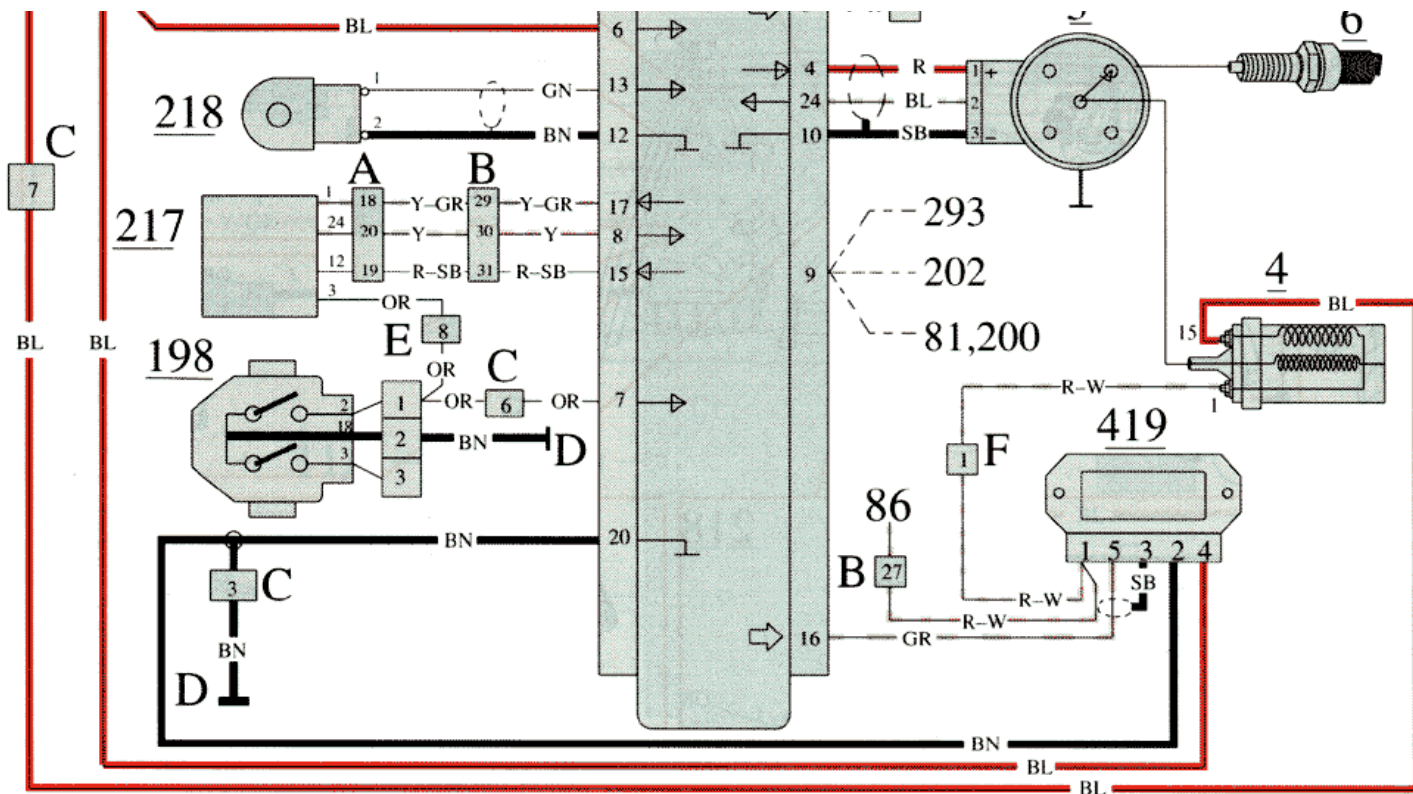

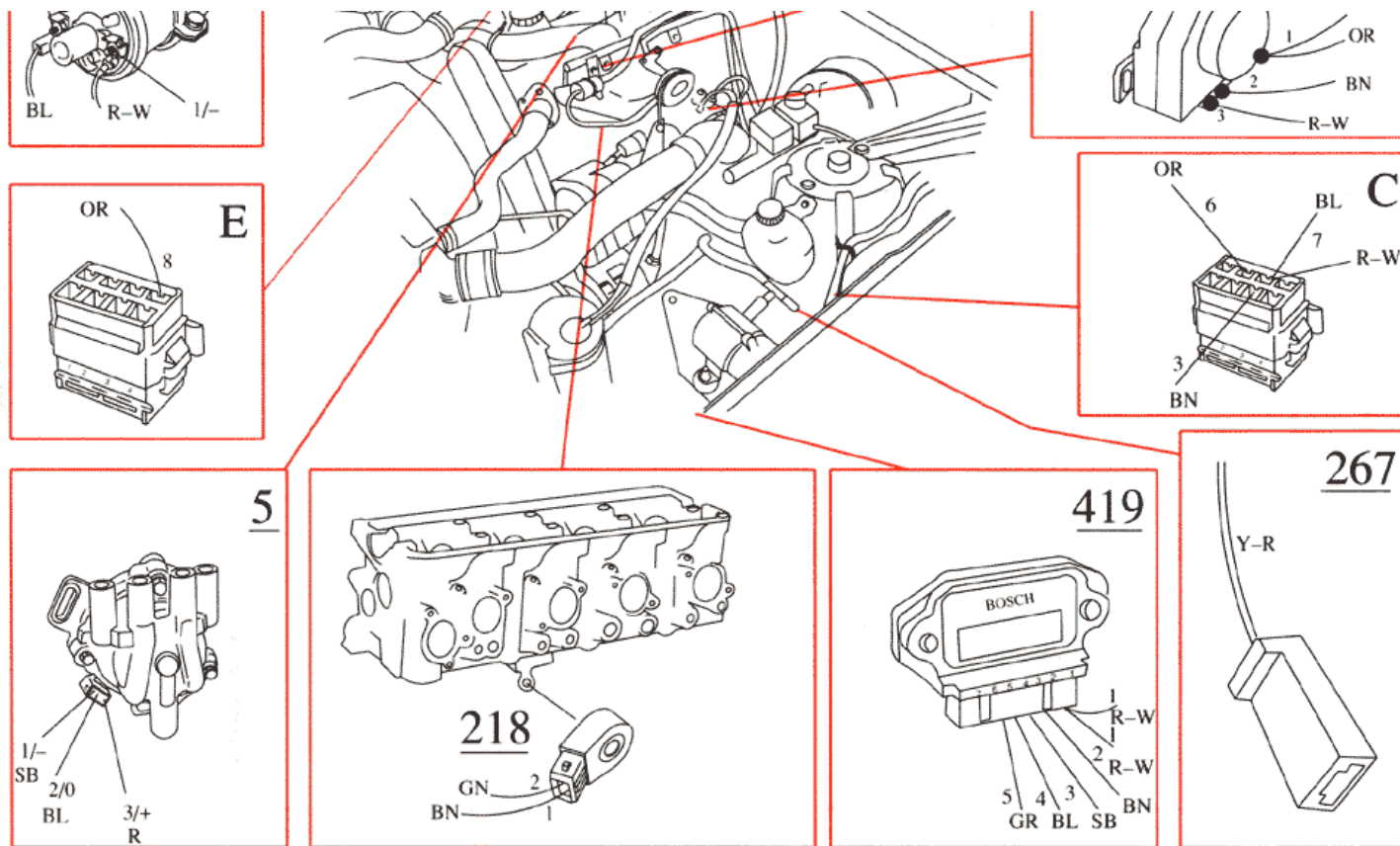

### EZ 118K Ignition system, B230K, B200/230E

- |                                 |                                      |                                    |
|---------------------------------|--------------------------------------|------------------------------------|
| 1 Battery                       | 200 AC compressor solenoid           | A Connector, right A-post          |
| 2 Ignition switch               | 202 Climate control panel            | B Connector, left A-post           |
| 4 Ignition coil                 | 217 Control unit LH 2.2              | C Connector, left suspension tower |
| 5 Distributor                   | 218 Knock sensor                     | D Ground point, inlet manifold     |
| 6 Spark plug                    | 224 Thermostat, electric cooling fan | E Connector, left suspension tower |
| 11 Fuse box                     | 232 Relay "hot-spot"                 |                                    |
| 29 Positive terminal            | 260 Control unit                     |                                    |
| 81 AC pressure sensor           | 267 Service socket                   |                                    |
| 84 Temperature sensor (B230K)   | 271 Fuel shut-off valve (solenoid)   |                                    |
| 86 Tachometer                   | 272 Microswitch                      |                                    |
| 119 Fuel pump relay             | 293 Relay, idle speed compensation   |                                    |
| 156 Motor, electric cooling fan | 419 Power stage                      |                                    |
| 198 Throttle switch             |                                      |                                    |

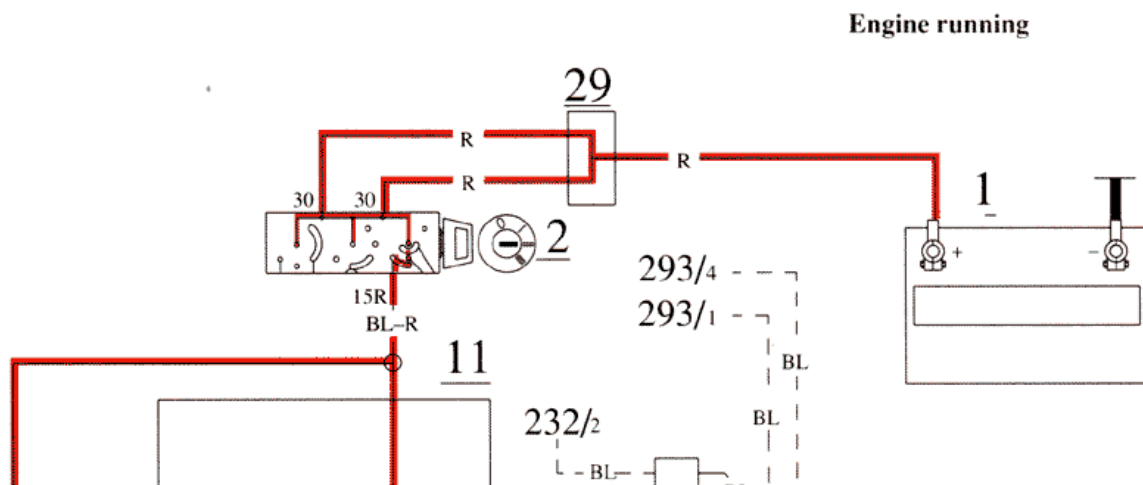



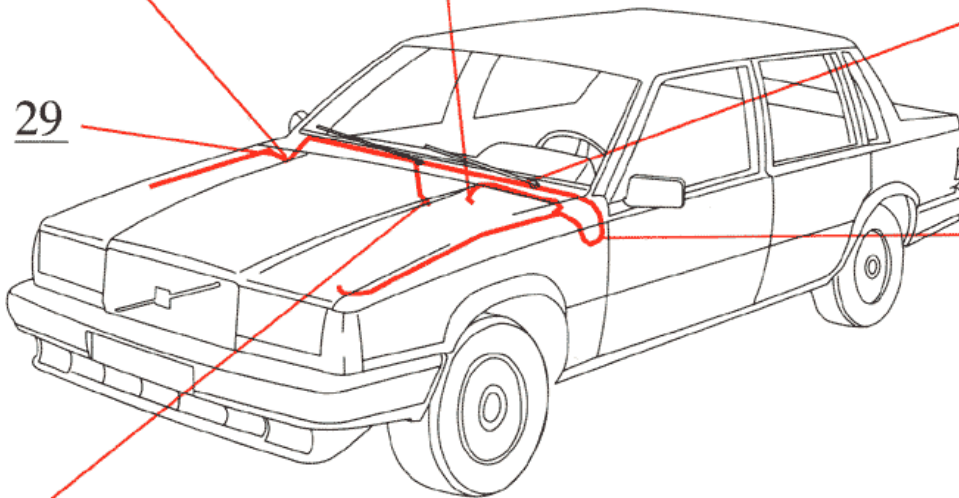
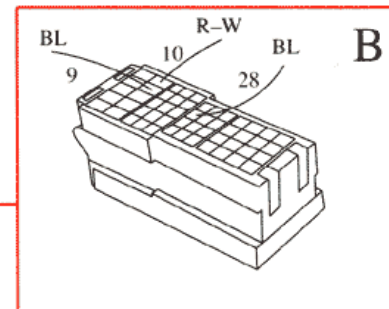
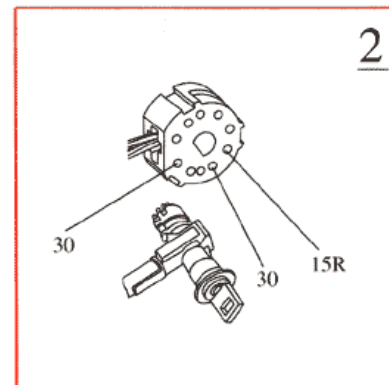
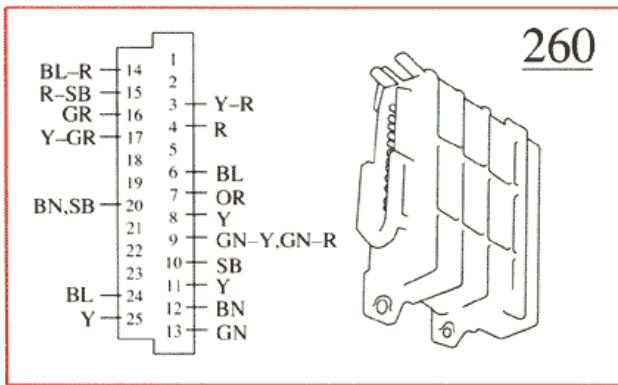
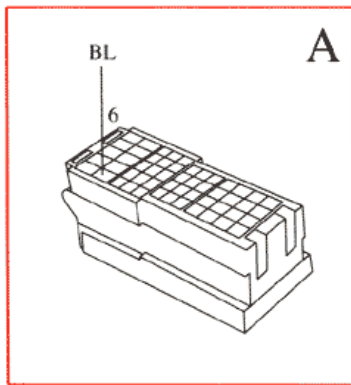
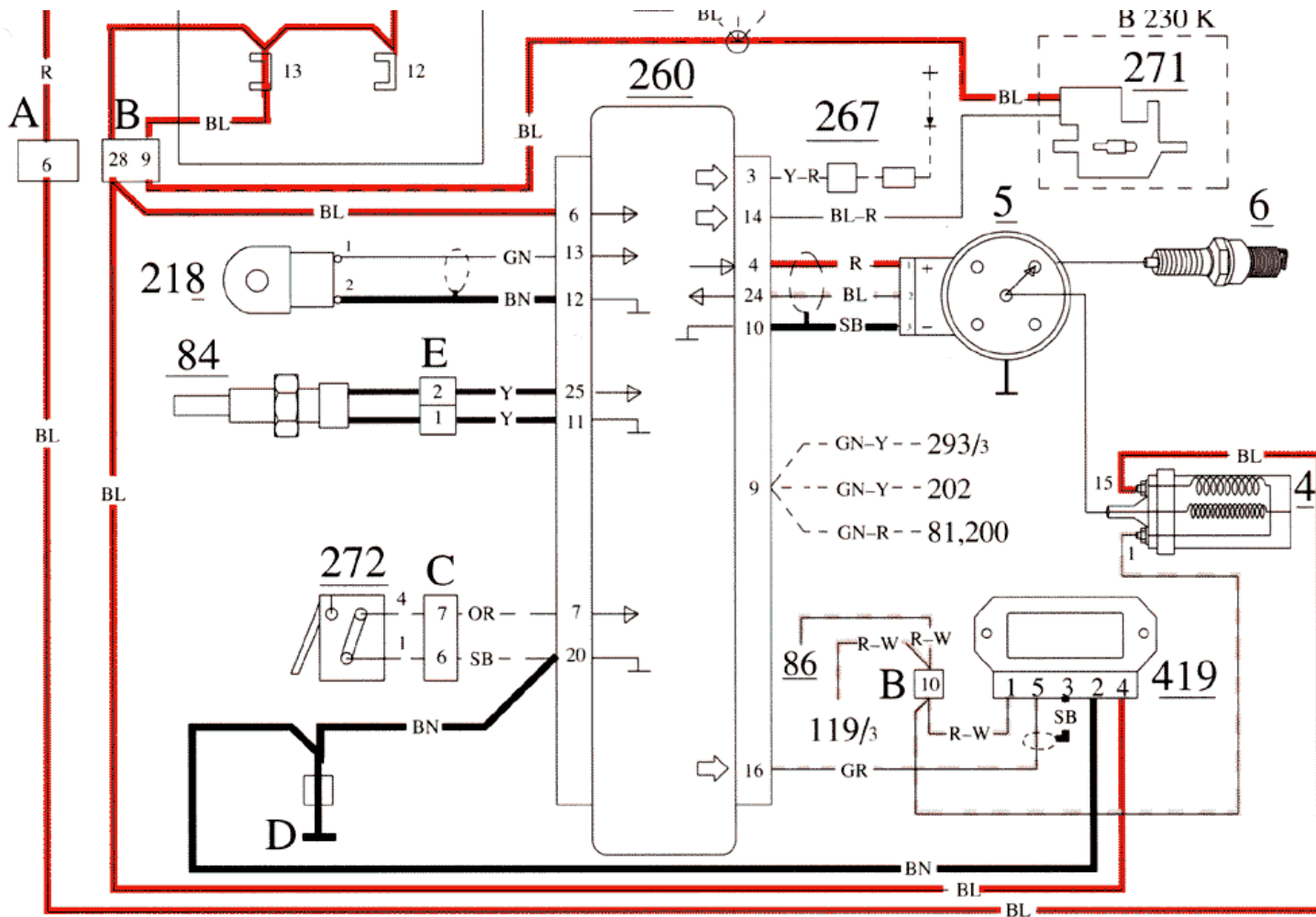

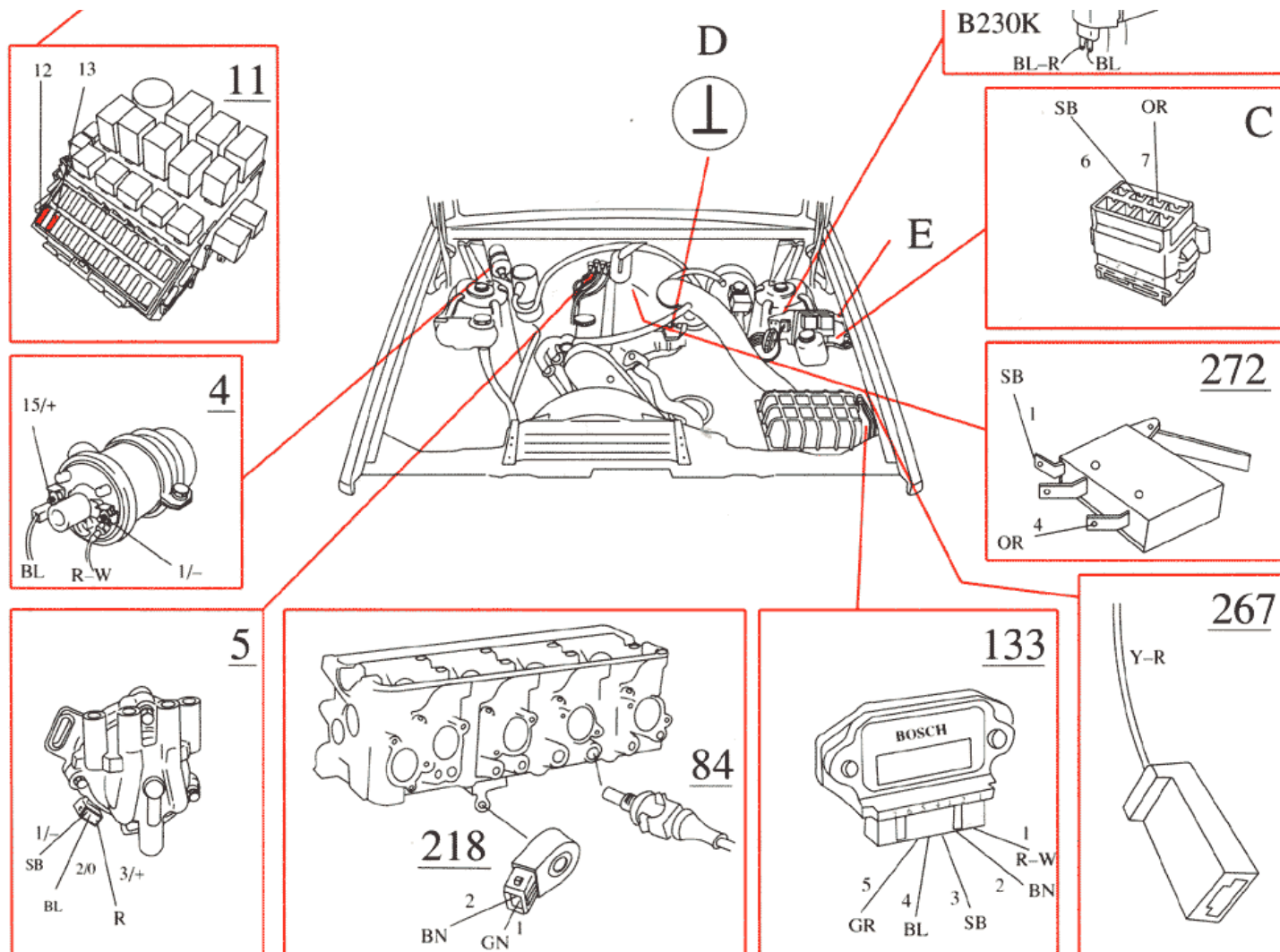

### Rex i Ignition system, B234F USA, Federal

- |   |   |
|---|---|
| <ul style="list-style-type: none"> <li>1 Battery</li> <li>2 Ignition switch</li> <li>5 Distributor</li> <li>6 Spark plug</li> <li>11 Fusebox</li> <li>12 Instrument connection, 12-pole</li> <li>29 Positive terminal</li> <li>31 Ground rail in electrical distribution unit</li> <li>84 Temperature sensor</li> <li>86 Tachometer</li> <li>198 Throttle switch</li> <li>218 Knock sensor</li> <li>260 Control unit, ignition system</li> <li>413 Impulse sensor</li> <li>419 Power stage/ignition coil</li> <li>472 Control unit, fuel system</li> <li>482 Diagnostic socket</li> </ul> | <ul style="list-style-type: none"> <li>A Connector, right A-post</li> <li>B Connector, left A-post</li> <li>C Connector, left suspension tower, 1-pole</li> <li>D Ground point, inlet manifold</li> <li>E Connector at bulkhead</li> <li>F Connector, left suspension tower</li> <li>G Connector, right suspension tower</li> <li>H Connector, left suspension tower</li> </ul> |
|---|---|

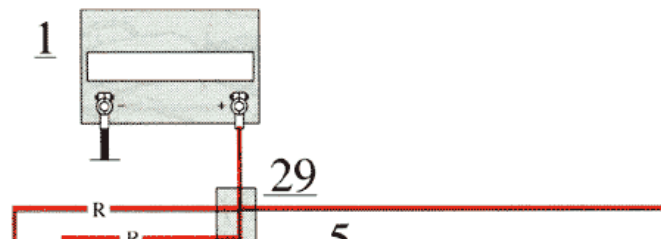



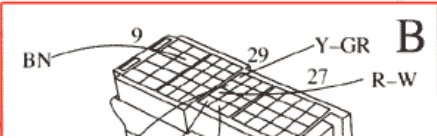
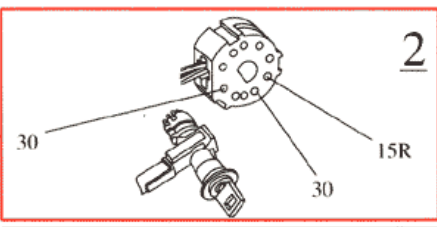
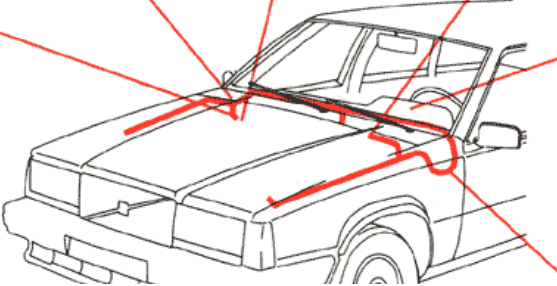
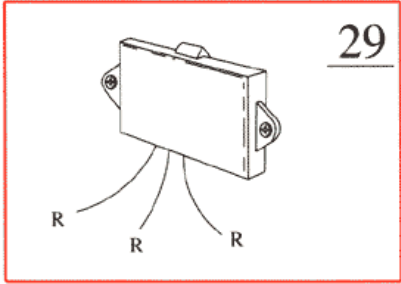
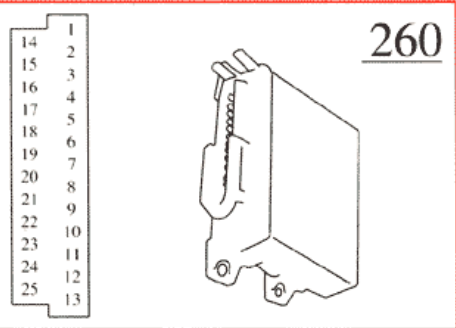
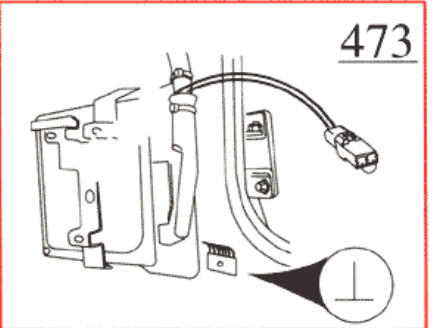
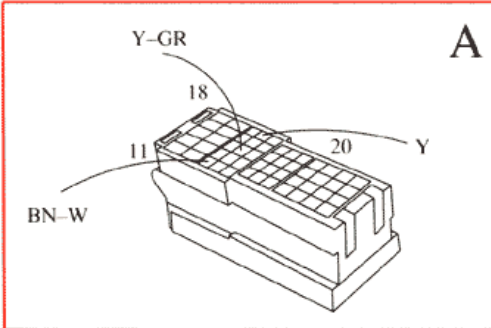
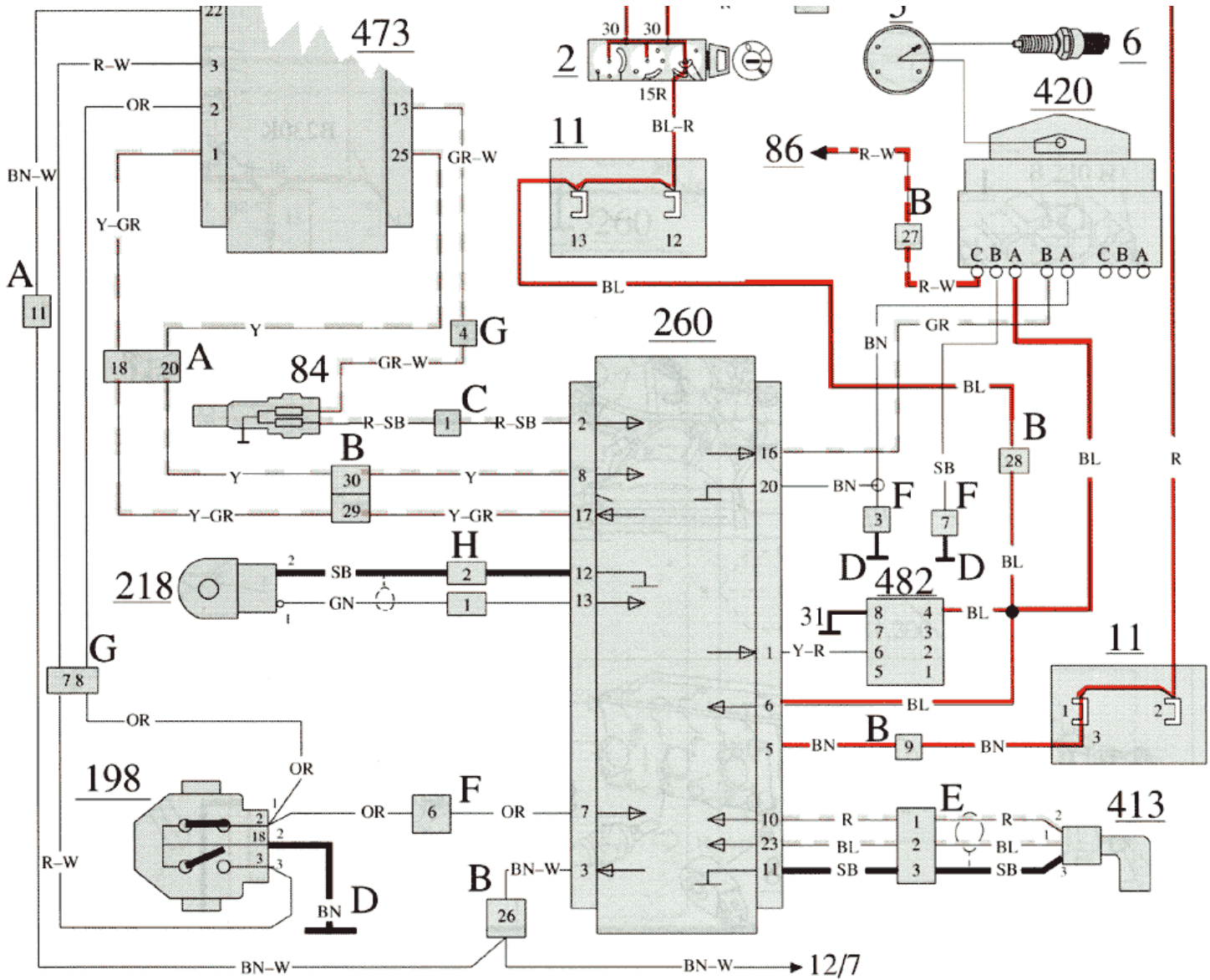

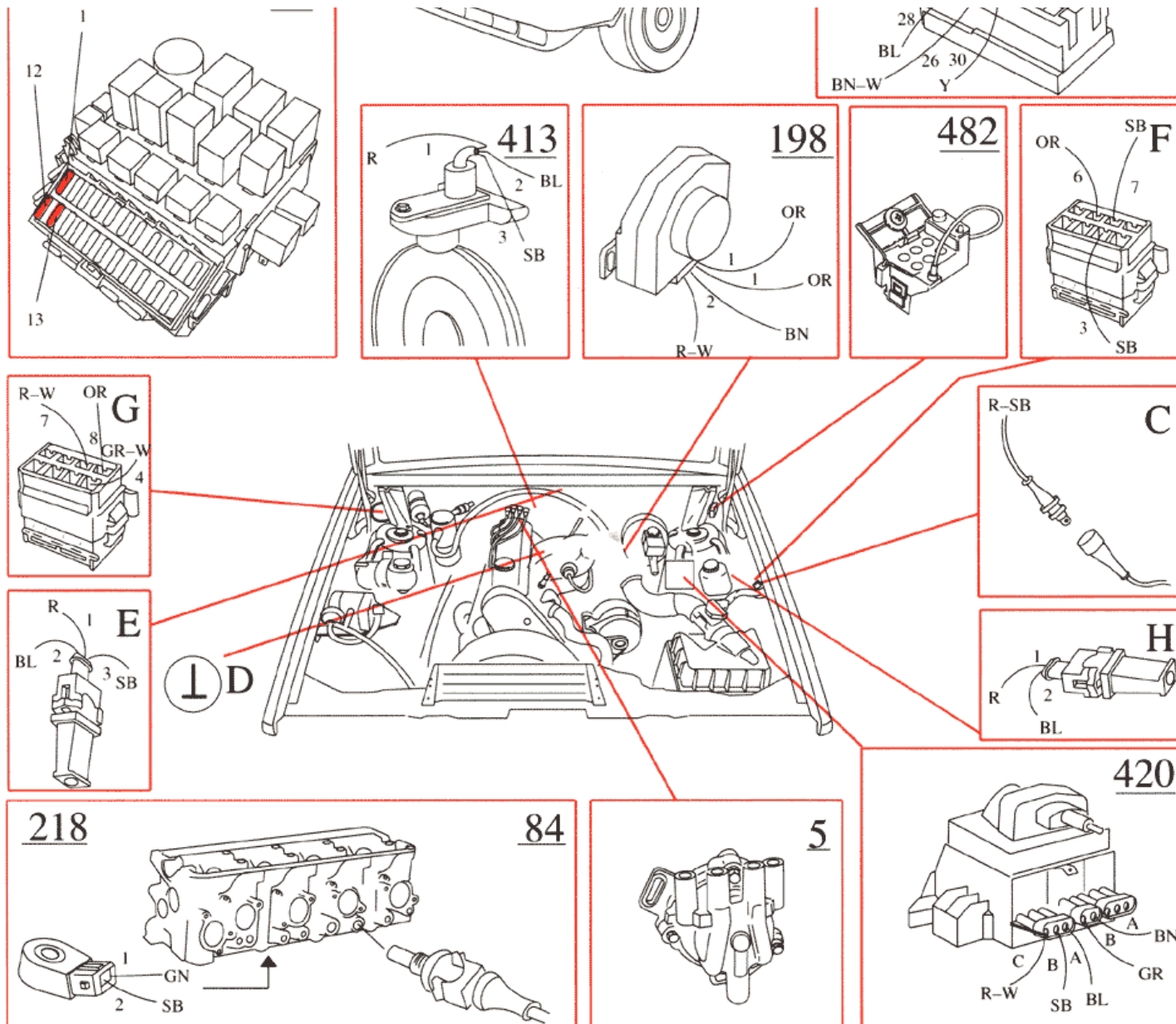

**Renix ignition system, B200K**



- 2 Ignition switch
- 3 4-pole connector at combined instrument
- 5 Distributor
- 6 Spark plug
- 11 Fuse box
- 29 Positive terminal
- 86 Tachometer
- 119 Relay, fuel pump
- 293 Relay, idle advance
- 406 Control unit, Renix
- 407 Pulse sender

- A Connector, left A-post
- B Connector, left suspension tower
- C connector, left suspension tower
- D Capacitor
- E Ground point
- F Ground point

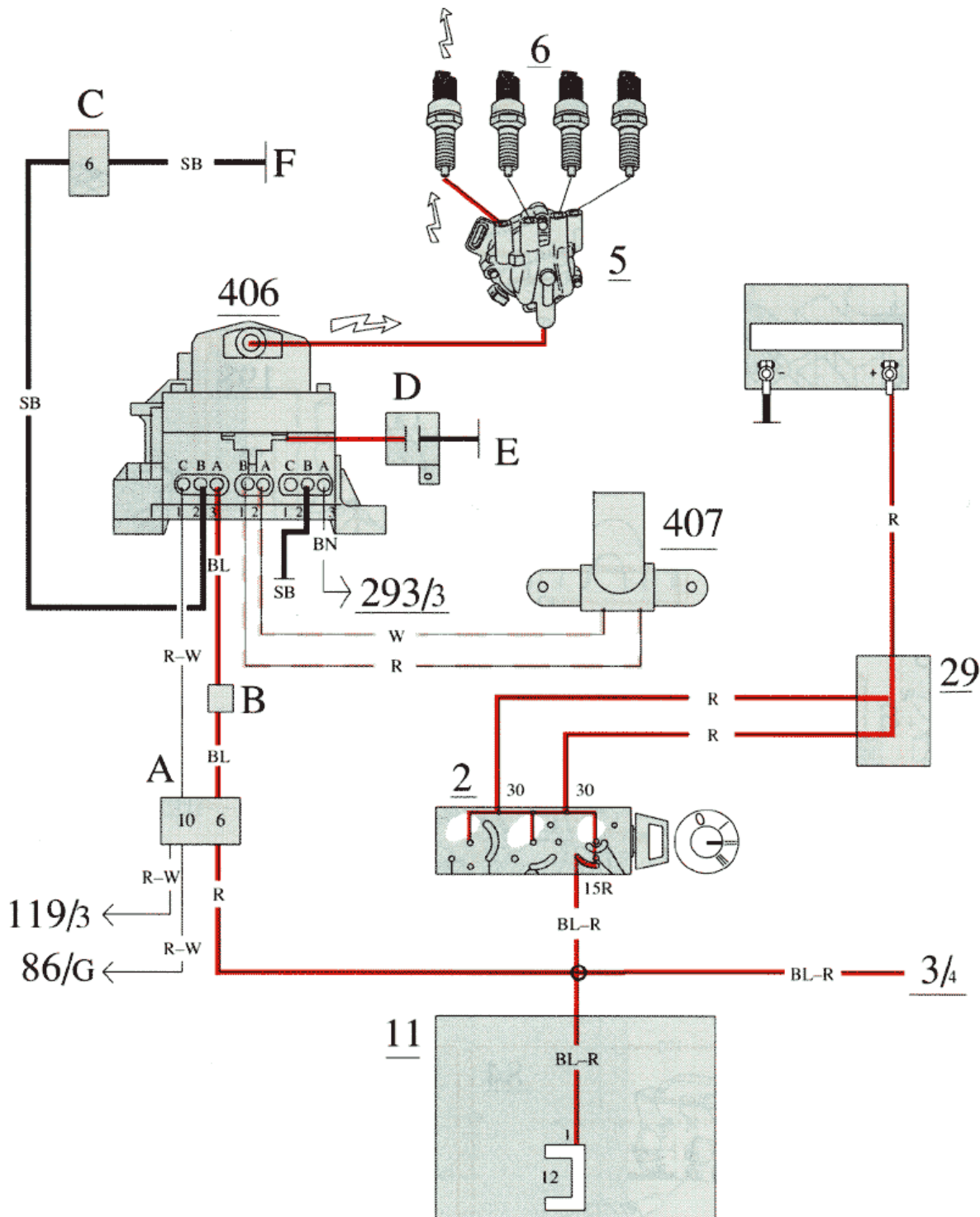

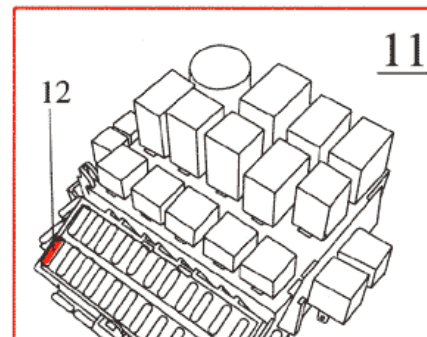
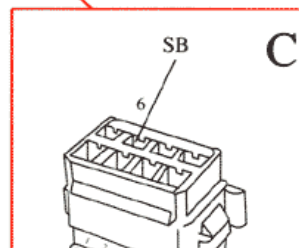
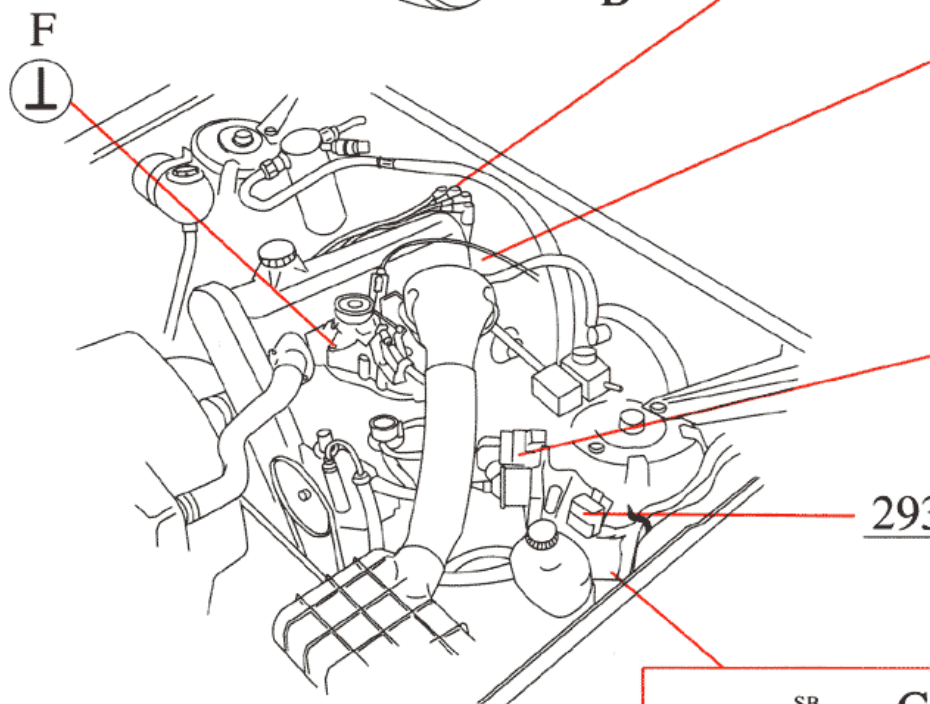
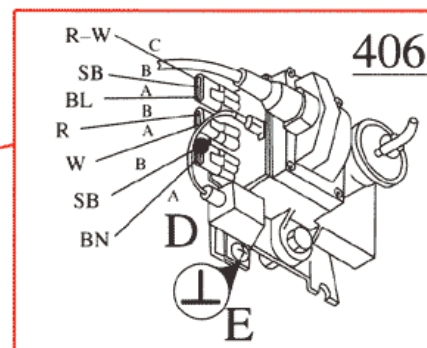
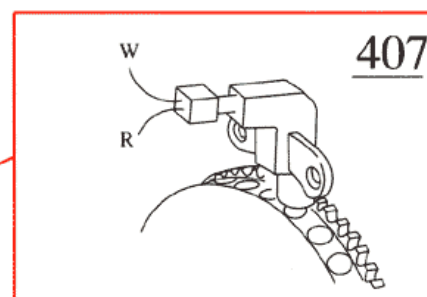
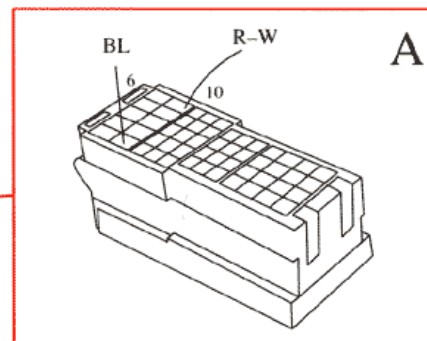
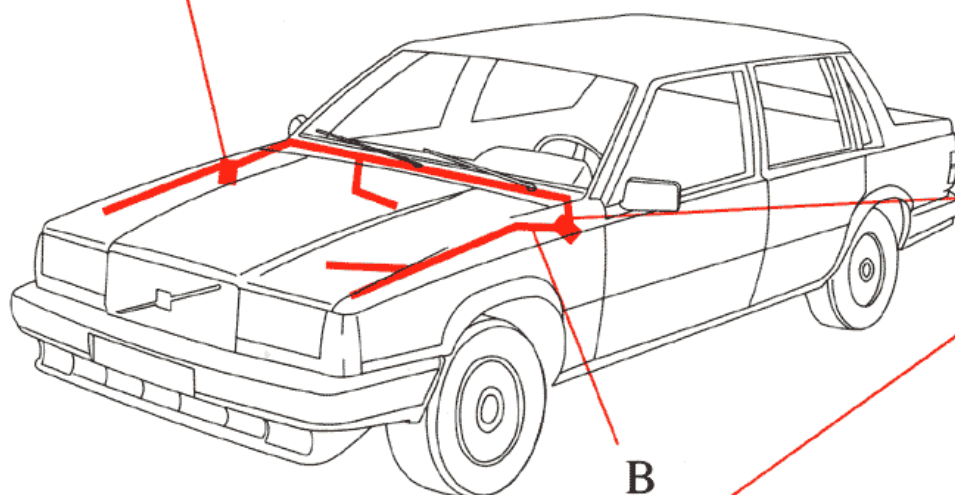
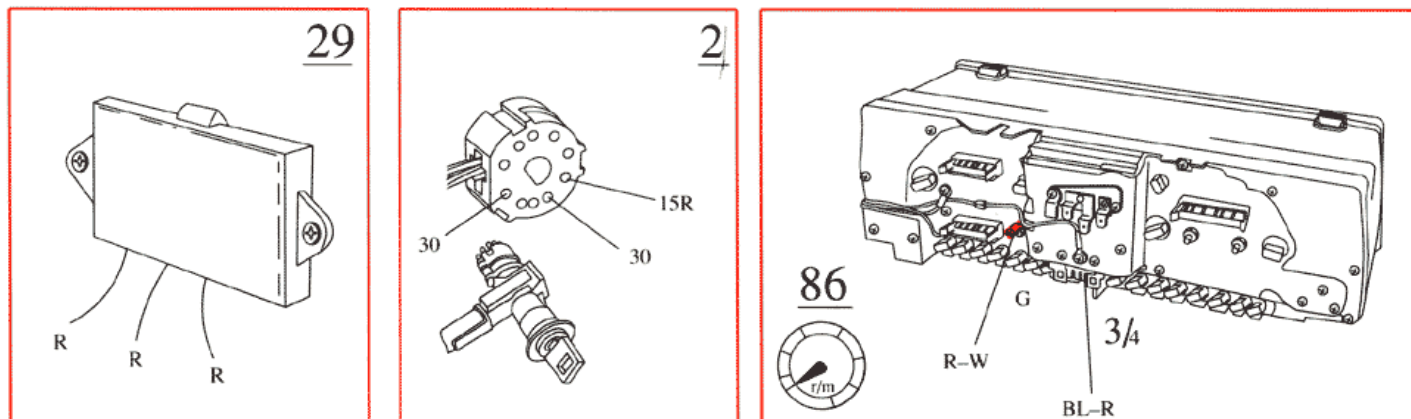



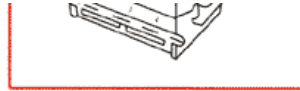

27.03.2000